



STATE OF NORTH CAROLINA  
DEPARTMENT OF TRANSPORTATION

JOSH STEIN  
GOVERNOR

DANIEL H. JOHNSON  
SECRETARY

February 5, 2026

**ADDENDUM # 1**

Contract Number: DN01144  
TIP Number: B-6034  
Federal Aid Number: BRZ-1300(018)  
WBS Number: 48229.3.1  
County: Jackson  
Description: Grading, Drainage, Paving, And Structure At Bridge No. 490065  
Over Savannah Creek On SR 1300 (Pumpkintown RD) in Jackson  
County

Letting Date: February 10, 2026

Plan Holders

**Content Summary: Provision Changes**

The above contract has experienced the following revisions:

1. Replace provision Project Special Provisions Permits beginning on page P-1 with the attached as all permits have been received

These revisions do not change bid items or the associated quantities.

There is no ebsx addenda file associated with this addendum.

Thank you for your attention to this matter.

If you have any questions, please contact the Division Proposal Engineer at (828) 331-5200.

Sincerely,

Signed by:

29BD93927CF24F6...

Jeanette L. White, P.E.  
Highway Division 14, Project Development-  
Team Lead

*Mailing Address:*  
NC DEPARTMENT OF TRANSPORTATION  
DIVISION OF HIGHWAYS - DIVISION 14  
253 WEBSTER ROAD  
SYLVA, NC 28779

*Telephone:* (828) 331-5200  
*Fax:* (828) 331-5201  
*Customer Service:* 1-877-368-4968

*Location:*  
253 WEBSTER ROAD  
SYLVA, NC 28779

*Website:* [www.ncdot.gov](http://www.ncdot.gov)

**PROJECT SPECIAL PROVISION**

(10-18-95) (Rev. 10-15-24)

Z-1

**PERMITS**

The Contractor's attention is directed to the following permits, which have been issued to the Department of Transportation by the authority granting the permit.

| <b><u>PERMIT</u></b>                                  | <b><u>AUTHORITY GRANTING THE PERMIT</u></b>              |
|---|--|
| Dredge and Fill and/or Work in Navigable Waters (404) | U. S. Army Corps of Engineers                            |
| Water Quality (401)                                   | Division of Water Resources, DEQ State of North Carolina |

The Contractor shall comply with all applicable permit conditions during construction of this project.

Agents of the permitting authority will periodically inspect the project for adherence to the permits.

The Contractor's attention is also directed to Articles 107-10 and 107-13 of the *Standard Specifications* and the following:

Should the Contractor propose to utilize construction methods (such as temporary structures or fill in waters and/or wetlands for haul roads, work platforms, cofferdams, etc.) not specifically identified in the permit (individual, general, or nationwide) authorizing the project it shall be the Contractor's responsibility to coordinate with the Engineer to determine what, if any, additional permit action is required. The Contractor shall also be responsible for initiating the request for the authorization of such construction method by the permitting agency. The request shall be submitted through the Engineer. The Contractor shall not utilize the construction method until it is approved by the permitting agency. The request normally takes approximately 60 days to process; however, no extensions of time or additional compensation will be granted for delays resulting from the Contractor's request for approval of construction methods not specifically identified in the permit.

**Where construction moratoriums are contained in a permit condition which restricts the Contractor's activities to certain times of the year, those moratoriums will apply only to the portions of the work taking place in the restricted waters, wetlands or buffer zones, provided that activities outside those areas is done in such a manner as to not affect the restricted waters, wetlands or buffer zones.**



STATE OF NORTH CAROLINA  
DEPARTMENT OF TRANSPORTATION

JOSH STEIN  
GOVERNOR

DANIEL H. JOHNSON  
SECRETARY

January 21, 2026

MEMORANDUM TO: Division Construction Unit  
Division Contracts Unit

FROM: Patrick Breedlove, Division PDEA Engineer DS  
PB  
Division Environmental Unit

SUBJECT: Environmental Permits for Bridge 490065 replacement on Pumpkintown Road (SR 1300) over Savannah Creek in Jackson County, Division 14.  
**STIP Number: B-6034**  
**WBS Number: 48229.3.1**  
**Federal Project Number: BRZ – 1300 (018)**

Please find enclosed the following permits for this project:

| Agency  | Permit Type                          | Permit Expiration |
|---|--------------------------------------|-------------------|
| US Army Corps of Engineers<br>Section 404 Clean Water Act Permit          | Regional General Permit 50           | May 30, 2030      |
| NC Division of Water Resources<br>Section 401 Water Quality Certification | Water Quality Certification No. 8503 | May 30, 2030      |

Work is authorized by the above referenced permit provided it is accomplished in strict accordance with the permitted plans.

The Division Environmental Office must be consulted if any deviation from the permit(s) is required.



**DEPARTMENT OF THE ARMY**  
U.S. ARMY CORPS OF ENGINEERS, WILMINGTON DISTRICT  
WRDA TRANSPORTATION BRANCH  
69 DARLINGTON AVENUE  
WILMINGTON NORTH CAROLINA 28403

January 21, 2026

Regulatory Division  
SAW-2025-02130

Sent Via email: [pjbreedlove@ncdot.gov](mailto:pjbreedlove@ncdot.gov)

North Carolina Department of Transportation  
Attn: Mr. Patrick Breedlove  
253 Webster Road  
Sylva, NC 28779

Dear Mr. Breedlove:

This letter is in response to the Pre-Construction Notification (PCN) you submitted to the Wilmington District, WRDA/Transportation Branch on November 18, 2025, for a Department of the Army Nationwide permit (NWP) verification. This project has been assigned the file number SAW-2025-02130 and is known as the Br 65 replacement project (B6034). This file number should be referenced in all correspondence concerning this project.

A review of the information provided indicates that the proposed work would include the replacement of an obsolete bridge with a new bridge and would result in the permanent impact to 53 lf of stream channel due to bank stabilization and the temporary impact to 50 lf due to dewatering. The Br 65 replacement project (B6034) is located where Pumpkintown Road crosses Savannah Creek, just east of the intersection of Pumpkintown Road and Victory Church Road in Sylva, Jackson County, North Carolina. Latitude 35.274389 and Longitude -83.289328.

We have determined that the proposed work is authorized by GP 50 pursuant to authorities under Section 404 of the Clean Water Act (33 U.S.C § 1344). The proposed work must be accomplished in strict accordance with the general permit conditions, any regional conditions, the special conditions listed in this letter, the application materials, and the enclosed plans. If the extent of the project area and/or nature of the authorized impacts to waters are modified, a revised PCN must be submitted to this office for written approval before work is initiated. Any violation of permit conditions or deviation from your submitted plans may subject the permittee to enforcement action.

This verification is valid until May 30, 2030, unless prior to this date the subject GP(s) is suspended, revoked, or is modified such that the activity no longer complies with the terms and conditions of this GP. If you commence or are under contract to commence this activity before the date that the relevant GP is modified or revoked, you

will have 12 months from the date of the modification or revocation of the GP to complete the activity under the present terms and conditions of this GP.

**Project Specific Special Conditions:**

- 1) The U.S. Fish and Wildlife Service's (USFWS's) Programmatic Biological (PBO) and Conference Opinion (PCO) and Programmatic Conference Report titled "Five Imperiled Bat Species in Western North Carolina" dated April 1, 2025, contains mandatory terms and conditions to implement the reasonable and prudent measures that are associated with "incidental take" that are specified in the PBO/PCO. The USFWS adopted the PBO/PCO as the Programmatic Biological Opinion (PBO) for the effects of this action on August 18, 2025. Your authorization under this Corps permit is conditional upon your compliance with all the mandatory terms and conditions associated with incidental take of the PBO, which terms and conditions are incorporated by reference in this permit. Failure to comply with the terms and conditions associated with incidental take of the PBO, where a take of the listed species occurs, would constitute an unauthorized take, and it would also constitute non-compliance with your Corps permit. The USFWS is the appropriate authority to determine compliance with the terms and conditions of its PBO, and with the ESA.
- 2) Per the NC Wildlife Resources Commission's 8/15/2025 letter, NCDOT The October 15 to April 15 trout moratoria should be adhered to for instream disturbance with this bridge construction. Applicable measures from the current *NCDOT Erosion and Sediment Control Design and Construction Manual* should be adhered to. *Design Standards in Sensitive Waters* should be incorporated into the project's erosion control to help ensure protection of potential trout spawning and high-quality habitat. Matting used in riparian areas should not contain nylon mesh because it entangles and kills wildlife. Coir matting should be used on disturbed stream banks that are steep or susceptible to high water. Matting should be anchored with wooden stakes according to NCDOT specifications.

This GP verification does not preclude the necessity to obtain any other Federal, State, or local permits, licenses, and/or certifications, which may be required.

If you have any questions related to this verification or have issues accessing documents referenced in this letter, please contact Crystal Amschler, WRDA / Transportation Branch Project Manager at 828-526-6013, by mail at the above address, or by email at [crystal.c.amschler@usace.army.mil](mailto:crystal.c.amschler@usace.army.mil). Please take a moment to complete our customer satisfaction survey located at <https://regulatory.ops.usace.army.mil/customer-service-survey/>.

Sincerely,



M. Scott Jones, PWS  
WRDA / Transportation Branch Chief  
USACE - Wilmington District

Enclosures

|  |  |
|--|--|
| <p>U.S. Army Corps of Engineers (USACE)</p> <p><b>CERTIFICATION OF COMPLIANCE WITH DEPARTMENT OF THE ARMY PERMIT</b></p> <p>For use of this form, see Section 404 of the Clean Water Act, Section 10 of the Rivers and Harbors Act of 1899, and Section 103 of the Marine Protection, Research, and Sanctuaries Act; the proponent agency is CECW-COR.</p> | <p><i>Form Approved -</i></p> <p><i>OMB No. 0710-0003</i></p> <p><i>Expires 2027-10-31</i></p> |
|--|--|

**The Agency Disclosure Notice (ADN)**

The Public reporting burden for this collection of information, 0710-0003, is estimated to average 10 minutes per response, including time for reviewing instructions, searching existing data sources, gathering and maintaining the data needed, and completing and reviewing the collection of information. Send comments regarding the burden estimate or burden reduction suggestions to the Department of Defense, Washington Headquarters Services, at [whs.mc-alex.esd.mbx.dd-dod-information-collections@mail.mil](mailto:whs.mc-alex.esd.mbx.dd-dod-information-collections@mail.mil). Respondents should be aware that notwithstanding any other provision of law, no person shall be subject to any penalty for failing to comply with a collection of information if it does not display a currently valid OMB control number.

**PURPOSE:** This form is used by recipients of U.S. Army Corps of Engineer Regulatory permits to certify compliance with the permit terms and conditions.

Your permitted activity is subject to a compliance inspection by a U.S. Army Corps of Engineers representative. If you fail to comply with this permit, you are subject to permit suspension, modification, or revocation.

Upon completion of the activity authorized by this permit and any mitigation required by the permit, sign this certification and return it to the U.S. Army Corps of Engineers, Wilmington District, Regulatory Office.

The certification can be submitted by email at [crystal.c.amschler@usace.army.mil](mailto:crystal.c.amschler@usace.army.mil) or by mail at the below address:

U.S. Army Corps of Engineers  
 Wilmington District Office  
 Street Address: 151 Patton Ave Rm 208  
 City: Asheville                      State: NC    Zip Code: 28801

**COMPLETED BY THE CORPS**

|   |   |
|---|---|
| Corps Action Number:                                    | SAW-2025-02130  |
| Permit Type: <u>General Permit</u>                      |   |
| General Permit Number and Name <i>(if applicable)</i> : |   |
| Name of Permittee:                                      | NCDOT   |
| Project Name:   | Br 65 replacement project (B6034)                     |
| Project Location <i>(physical address)</i> :            | located where Pumpkintown Road crosses Savannah Creek |
|   | Sylva, North Carolina                                 |

**PERMITTEE'S CERTIFICATION**

Date Work Started: \_\_\_\_\_

Date Work Completed: \_\_\_\_\_

Enclose photographs showing the completed project *(if available)*.

I \_\_\_\_\_ hereby certify that the work authorized by the above referenced permit has been completed in accordance with all of the permit terms and conditions, and that any required compensatory mitigation has been completed in accordance with the permit conditions.

|      |      |           |
|------|------|-----------|
| Name | Date | Signature |
|------|------|-----------|



North Carolina Department of Transportation

Highway Stormwater Program  
STORMWATER MANAGEMENT PLAN

FOR NCDOT PROJECTS



(Version 3.02; Released April 23, 2024)

WBS Element: 48229.1.1      TIP/Proj No: B-6034      County(ies): Jackson      Page 1 of 2

General Project Information

|                                 |   |             |                        |  |                    |       |            |
|---------------------------------|---|-------------|------------------------|--|--------------------|-------|------------|
| WBS Element:                    | 48229.1.1                                   | TIP Number: | B-6034                 | Project Type:                            | Bridge Replacement | Date: | 12/19/2024 |
| NCDOT Contact:                  | Zachary Shuler, PE                          |             | Contractor / Designer: |  | Steve Rackley, PE  |       |            |
| Address:                        | 345 Toot Hollow Rd<br>Bryson City, NC 28713 |             | Address:               | 1318-F Patton Ave<br>Asheville, NC 28806 |                    |       |            |
| Phone:                          | 828-488-0902                                |             | Phone:                 | (919) 977-9455                           |                    |       |            |
| Email:                          | ztshuler@ncdot.gov                          |             | Email:                 | sdrackley@imt.com                        |                    |       |            |
| City/Town:                      | Sylva                                       |             | County(ies):           | Jackson                                  |                    |       |            |
| River Basin(s):                 | Little Tennessee                            |             | CAMA County?           | No                                       |                    |       |            |
| Wetlands within Project Limits? | No  |             |                        |  |                    |       |            |

Project Description

|  |   |                       |   |
|--|---|-----------------------|---|
| Project Length (lin. miles or feet):   | 0.10  | Surrounding Land Use: | Rural   |
| Proposed Project                       |   | Existing Site         |   |
| Project Built-Upon Area (ac.)          | 0.4   | ac.                   | 0.4   |
| ac.                                    |   |                       | ac.   |
| Typical Cross Section Description:     | two 10' travel lanes, one in each direction with 3' shoulders. 30' wide concrete cored slab bridge. |                       | two travel lanes, one in each direction over concrete bridge with wingwalls |
| Annual Avg Daily Traffic (veh/hr/day): | Design/Future:  | Year: 2045            | Existing: 1060  |
|  |   |                       | Year: 2025  |

General Project Narrative:  
(Description of Minimization of Water Quality Impacts)

B-6034 involves the replacement of Bridge 490065 in Jackson County along Pumpkintown Rd at the Savannah Creek crossing. The existing typical section is a two-lane undivided roadway. The roadway will be replaced with a two-lane undivided roadway with 10' travel lane. The proposed cored slab bridge will be 30' wide and have a span length of 70'. The existing drainage will be removed and replaced with new roadway ditches and a small closed system. Rip Rap pads are used at outlets throughout the project to reduce water velocities into the jurisdictional stream.



North Carolina Department of Transportation

Highway Stormwater Program  
**STORMWATER MANAGEMENT PLAN**  
 FOR NCDOT PROJECTS



(Version 3.02; Released April 23, 2024)

WBS Element: 48229.1.1      TIP/Proj No.: B-6034      County(ies): Jackson      Page 2 of 2

**General Project Information**

**Waterbody Information**

|  |                              |  |                         |  |     |
|--|------------------------------|--|-------------------------|--|-----|
| Surface Water Body (1):  | Savannah Creek               |  | NCDWR Stream Index No.: | 2-79-36  |     |
| NCDWR Surface Water Classification for Water Body                | Primary Classification:      |  | Class C                 |  |     |
|  | Supplemental Classification: |  | Trout Waters (Tr)       |  |     |
| Other Stream Classification:                                     |                              |  |                         |  |     |
| Impairments:   |                              |  |                         |  |     |
| Aquatic T&E Species?   |                              | Comments:  |                         |  |     |
| NRTR Stream ID:  |                              |  |                         | Buffer Rules in Effect:  | N/A |
| Project Includes Bridge Spanning Water Body?                     | Yes                          | Deck Drains Discharge Over Buffer?                               | No                      | Dissipator Pads Provided in Buffer?  | No  |
| Deck Drains Discharge Over Water Body?                           | No                           | (If yes, provide justification in the General Project Narrative) |                         | (If yes, describe in the General Project Narrative; if no, justify in the General Project Narrative) |     |
| (If yes, provide justification in the General Project Narrative) |                              |  |                         |  |     |

|  |                              |  |                         |  |  |
|--|------------------------------|--|-------------------------|--|--|
| Surface Water Body (2):  |                              |  | NCDWR Stream Index No.: |  |  |
| NCDWR Surface Water Classification for Water Body                | Primary Classification:      |  |                         |  |  |
|  | Supplemental Classification: |  |                         |  |  |
| Other Stream Classification:                                     |                              |  |                         |  |  |
| Impairments:   |                              |  |                         |  |  |
| Aquatic T&E Species?   |                              | Comments:  |                         |  |  |
| NRTR Stream ID:  |                              |  |                         | Buffer Rules in Effect:  |  |
| Project Includes Bridge Spanning Water Body?                     |                              | Deck Drains Discharge Over Buffer?                               |                         | Dissipator Pads Provided in Buffer?  |  |
| Deck Drains Discharge Over Water Body?                           |                              | (If yes, provide justification in the General Project Narrative) |                         | (If yes, describe in the General Project Narrative; if no, justify in the General Project Narrative) |  |
| (If yes, provide justification in the General Project Narrative) |                              |  |                         |  |  |

|  |                              |  |                         |  |  |
|--|------------------------------|--|-------------------------|--|--|
| Surface Water Body (3):  |                              |  | NCDWR Stream Index No.: |  |  |
| NCDWR Surface Water Classification for Water Body                | Primary Classification:      |  |                         |  |  |
|  | Supplemental Classification: |  |                         |  |  |
| Other Stream Classification:                                     |                              |  |                         |  |  |
| Impairments:   |                              |  |                         |  |  |
| Aquatic T&E Species?   |                              | Comments:  |                         |  |  |
| NRTR Stream ID:  |                              |  |                         | Buffer Rules in Effect:  |  |
| Project Includes Bridge Spanning Water Body?                     |                              | Deck Drains Discharge Over Buffer?                               |                         | Dissipator Pads Provided in Buffer?  |  |
| Deck Drains Discharge Over Water Body?                           |                              | (If yes, provide justification in the General Project Narrative) |                         | (If yes, describe in the General Project Narrative; if no, justify in the General Project Narrative) |  |
| (If yes, provide justification in the General Project Narrative) |                              |  |                         |  |  |

**PROJECT: B-6034**

**CONTRACT:**

See Sheet 1A For Index of Sheets

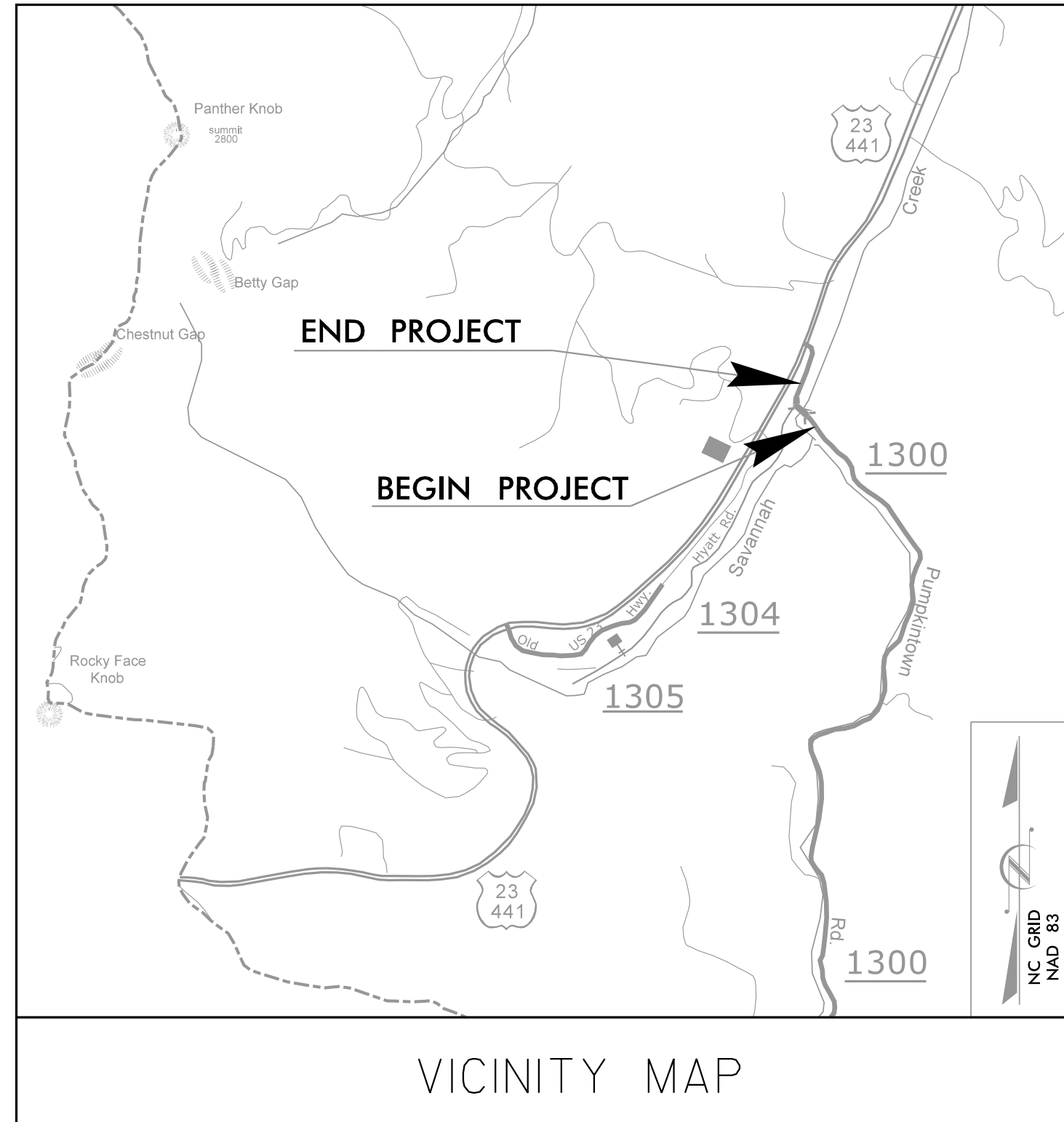

STATE OF NORTH CAROLINA  
DIVISION OF HIGHWAYS

# JACKSON COUNTY

**LOCATION: BRIDGE NO. 490065 OVER SAVANNAH CREEK  
ON SR 1300 (PUMPKINTOWN RD)**

**TYPE OF WORK: GRADING, DRAINAGE, PAVING, AND STRUCTURE**

**WETLAND AND SURFACE WATER IMPACTS PERMIT**

1.30.2025

| STATE              | STATE PROJECT REFERENCE NO. | SHEET NO.     | TOTAL SHEETS |
|--------------------|-----------------------------|---------------|--------------|
| N.C.               | <b>B-6034</b>               | 1             |              |
| JACKSON NO. 490065 |                             |               |              |
| STATE PROJ. NO.    | F.A. PROJ. NO.              | DESCRIPTION   |              |
| 48229.1.1          | BRZ-1300(018)               | PE            |              |
| 48229.2.1          | BRZ-1300(018)               | ROW/Utilities |              |
| 48229.3.1          | BRZ-1300(018)               | Construction  |              |

**PERMIT DRAWING  
SHEET 1 OF 5**

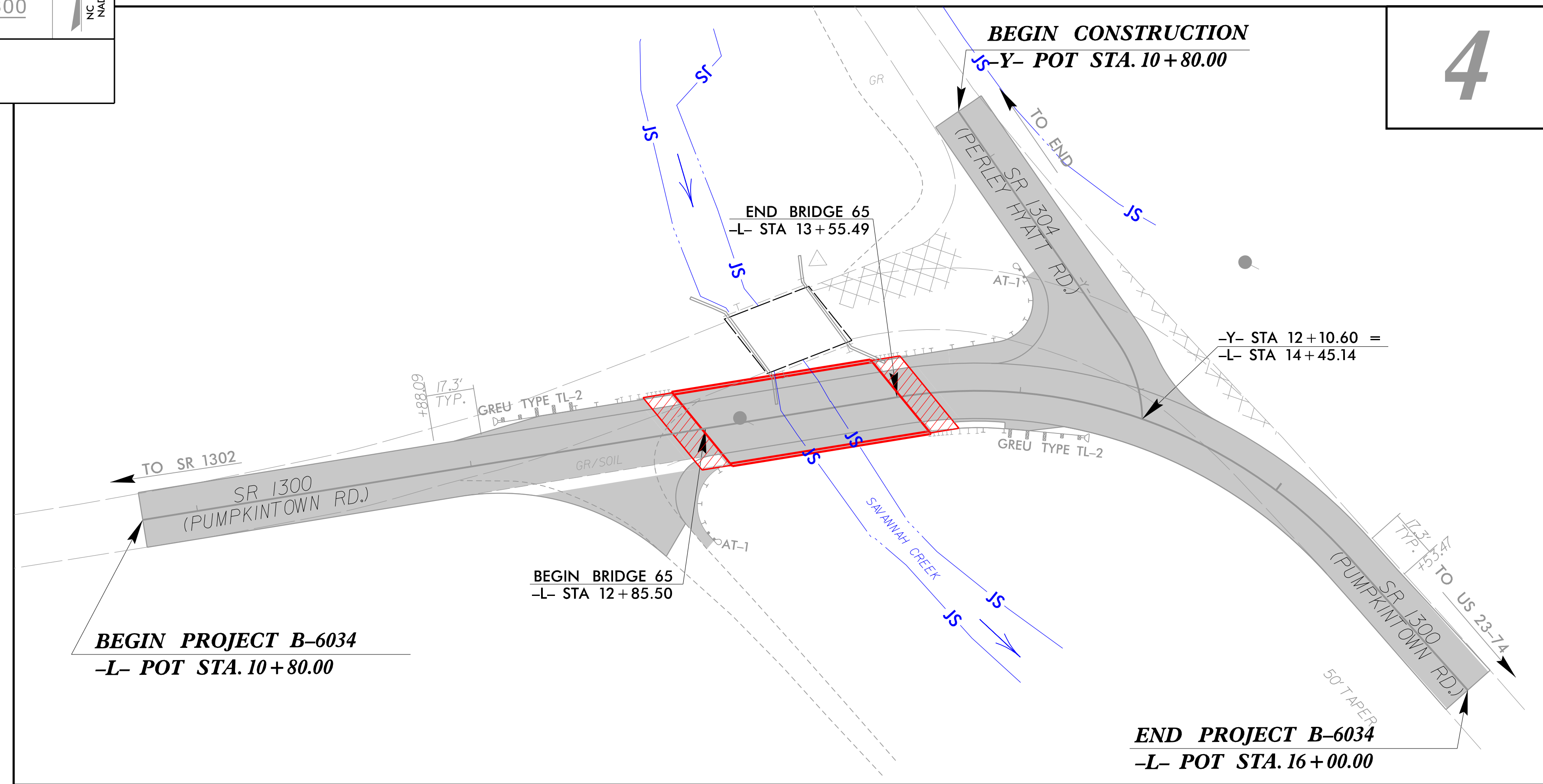
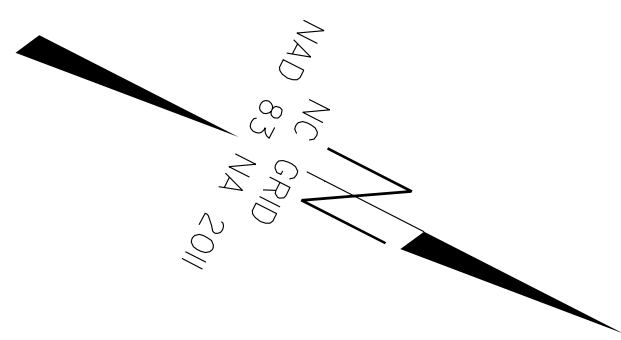

**PRELIMINARY PLANS  
DO NOT USE FOR CONSTRUCTION  
DOCUMENT NOT CONSIDERED FINAL  
UNLESS ALL SIGNATURES COMPLETED**

**GRAPHIC SCALES**

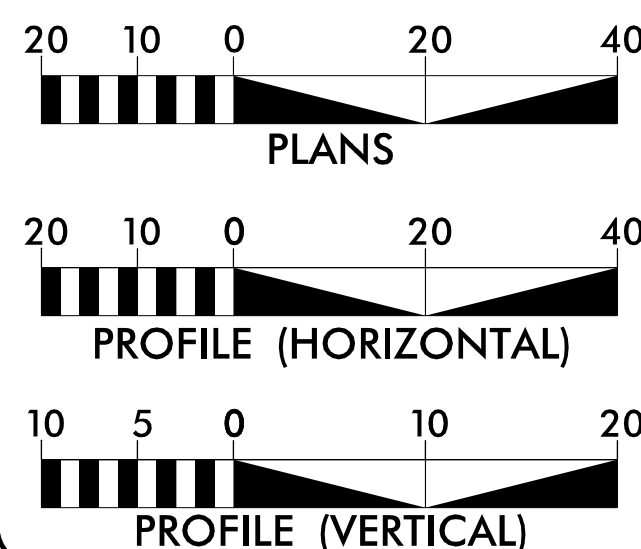

**DESIGN DATA**

ADT 2010 = 580  
ADT 2025 = 1060  
T = 6 % \*  
V = 35 MPH  
  
FUNC CLASS =  
RURAL LOCAL  
SUBREGIONAL

**PROJECT LENGTH**

LENGTH ROADWAY PROJECT B-6034 -L- = 0.085 MI  
LENGTH STRUCTURE PROJECT B-6034 -L- = 0.013 MI  
LENGTH ROADWAY PROJECT B-6034 -Y- = 0.025 MI

Prepared In the Office of:  
**DIVISION OF HIGHWAYS**  
1000 Birch Ridge Dr., Raleigh NC, 27610

2012 STANDARD SPECIFICATIONS

RIGHT OF WAY DATE:

LETTING DATE:

**JOHN LANSFORD, PE**  
PROJECT ENGINEER

**ALEX FITZPATRICK**  
PROJECT DESIGN ENGINEER

NCDOT CONTACT:  
**ZACHARY SHULER**  
DIVISION 14 BRIDGE PROJECT MANAGER

**HYDRAULICS ENGINEER**

SIGNATURE: \_\_\_\_\_ P.E.

**ROADWAY DESIGN  
ENGINEER**

SIGNATURE: \_\_\_\_\_ P.E.

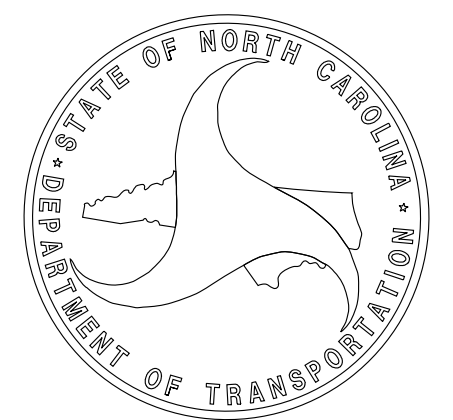

**PERMIT DRAWING  
SHEET 2 OF 5**

DOCUMENT NOT CONSIDERED FINAL  
UNLESS ALL SIGNATURES COMPLETED

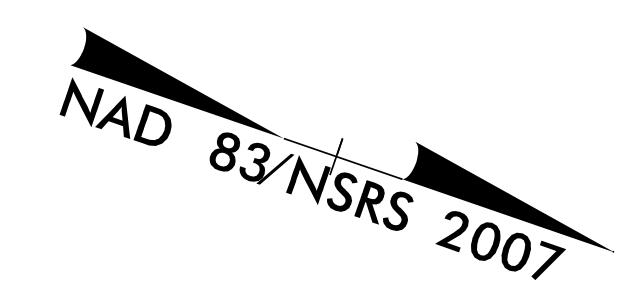

REVISIONS

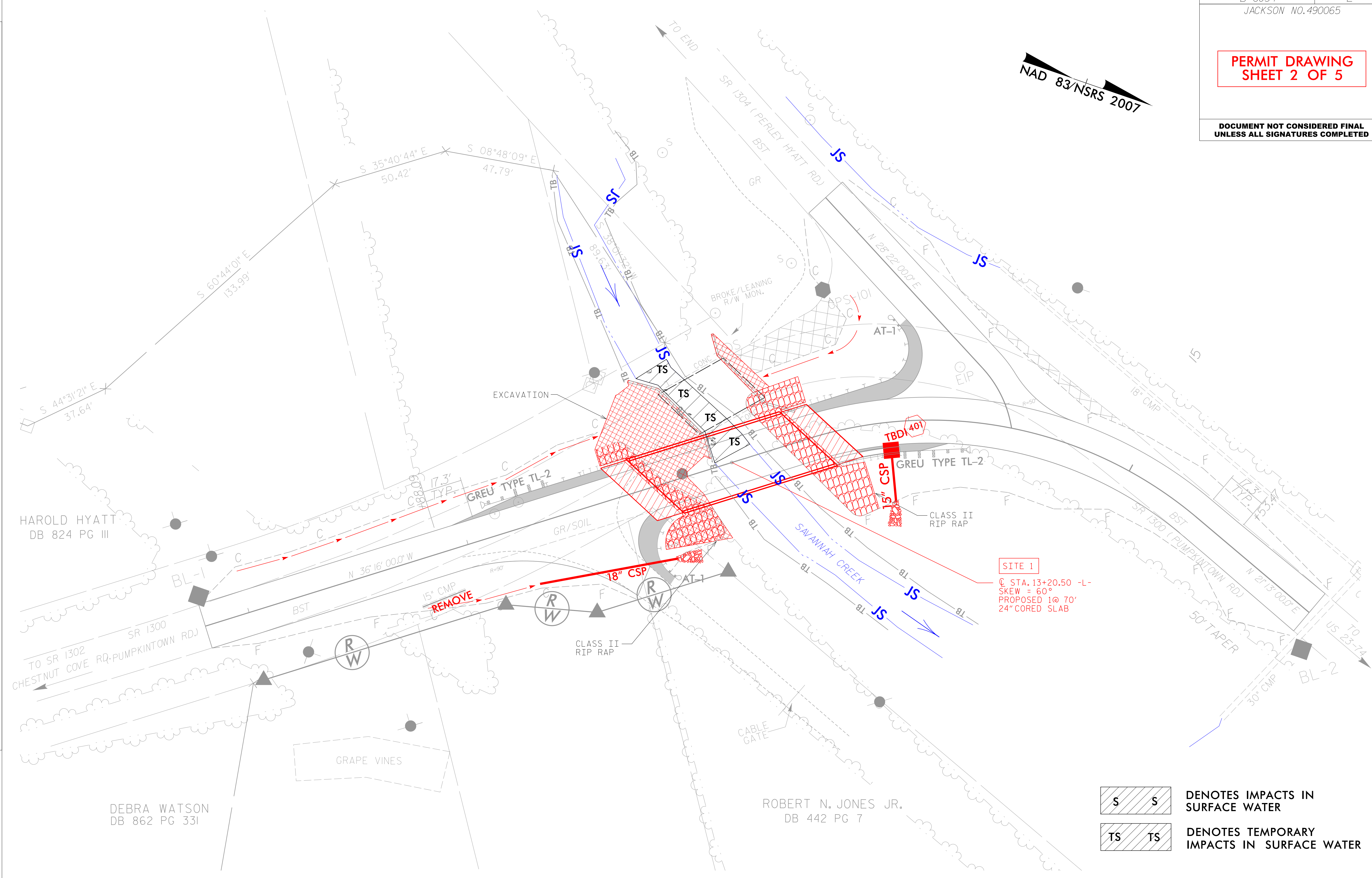

HAROLD HYATT  
DB 824 PG III

DEBRA WATSON  
DB 862 PG 331

ROBERT N. JONES JR.  
DB 442 PG 7

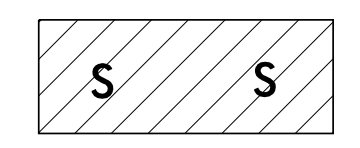

DENOTES IMPACTS IN  
SURFACE WATER



DENOTES TEMPORARY  
IMPACTS IN SURFACE WATER

**PERMIT DRAWING  
SHEET 3 OF 5**

**DOCUMENT NOT CONSIDERED FINAL  
UNLESS ALL SIGNATURES COMPLETED**

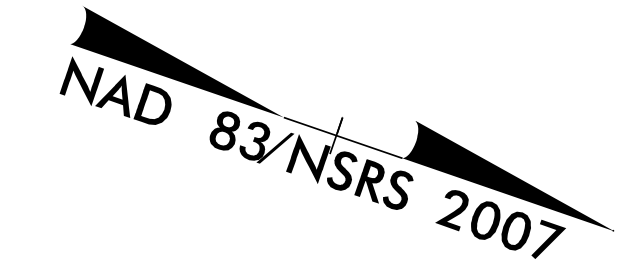

REVISIONS

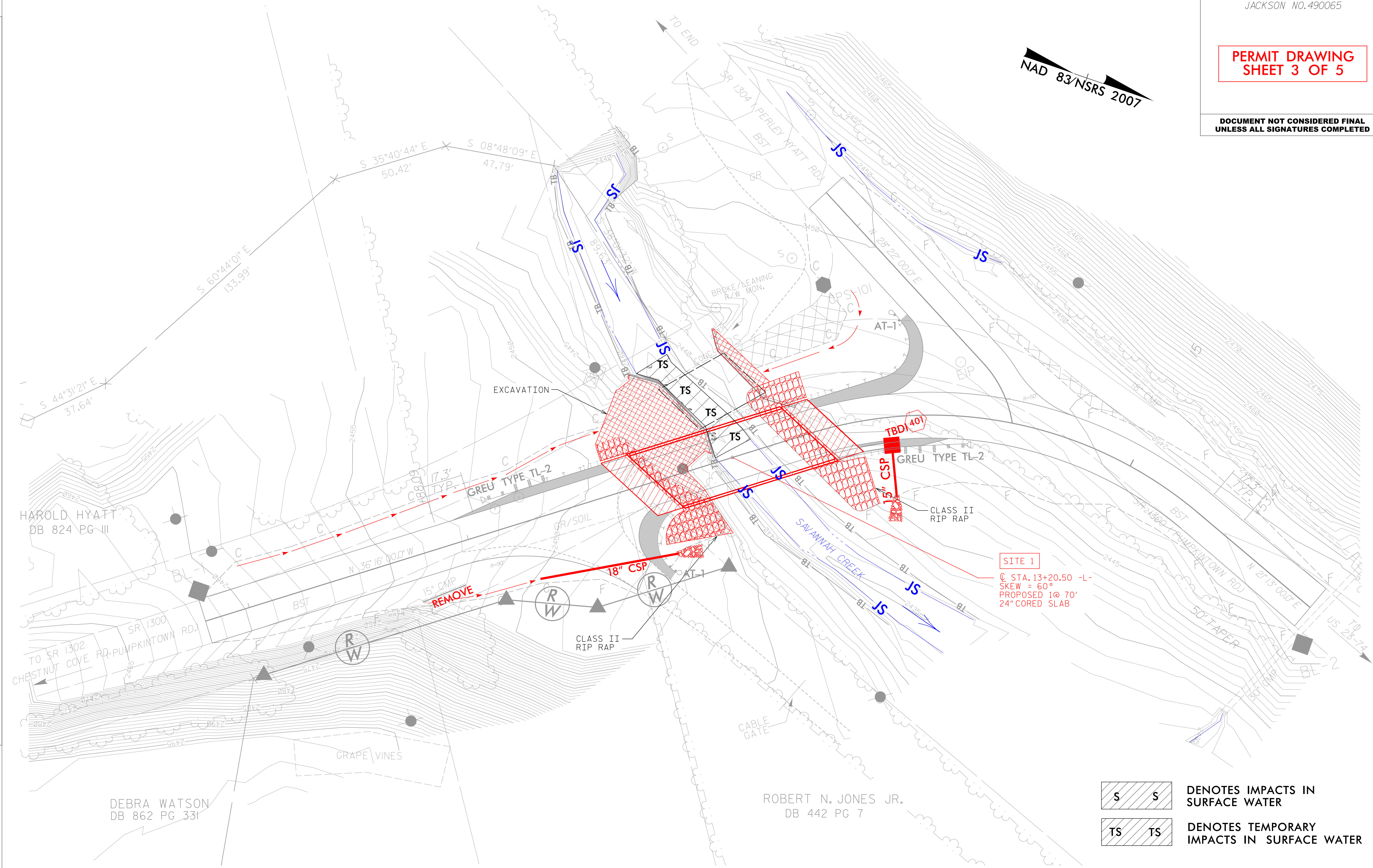

**SITE 1**

© STA. 13+20.50 -L-  
SKEW = 60°  
PROPOSED 1@ 70'  
24" CORED SLAB

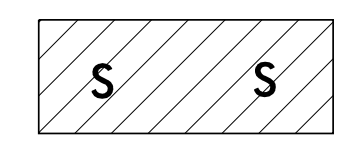

**DENOTES IMPACTS IN  
SURFACE WATER**



**DENOTES TEMPORARY  
IMPACTS IN SURFACE WATER**

HAROLD HYATT  
DB 824 PG III

DEBRA WATSON  
DB 862 PG 331

ROBERT N. JONES JR.  
DB 442 PG 7

**PERMIT DRAWING  
SHEET 4 OF 5**

DOCUMENT NOT CONSIDERED FINAL  
UNLESS ALL SIGNATURES COMPLETED

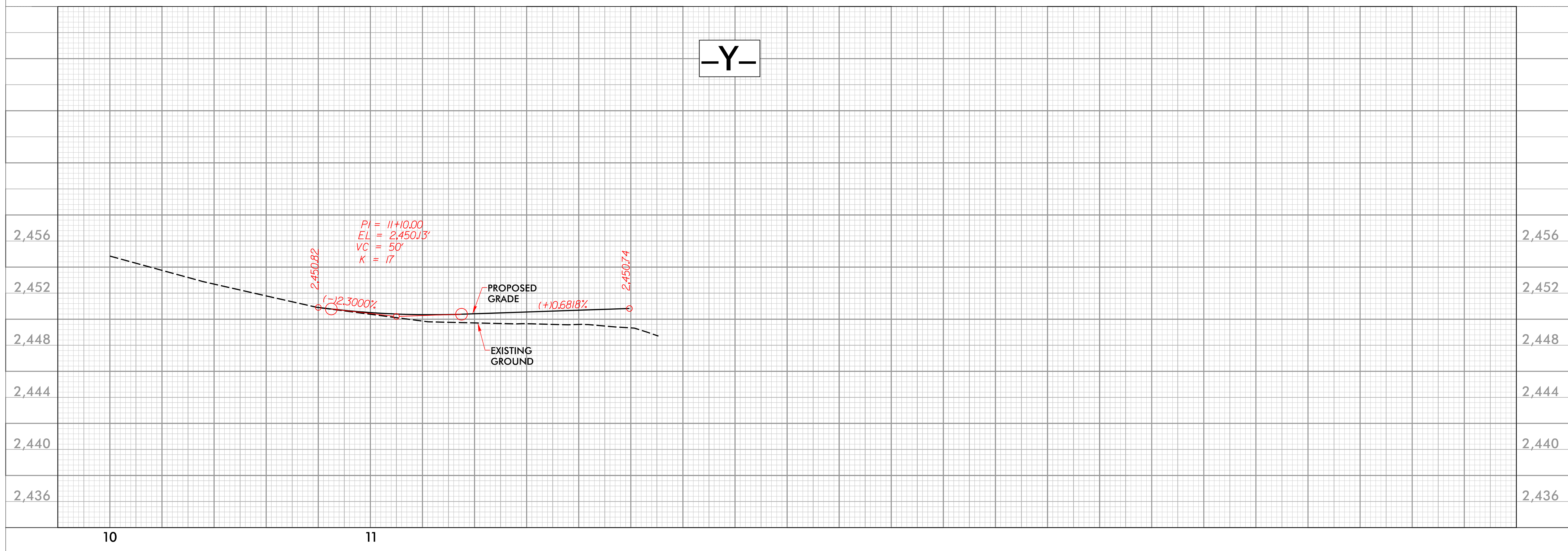
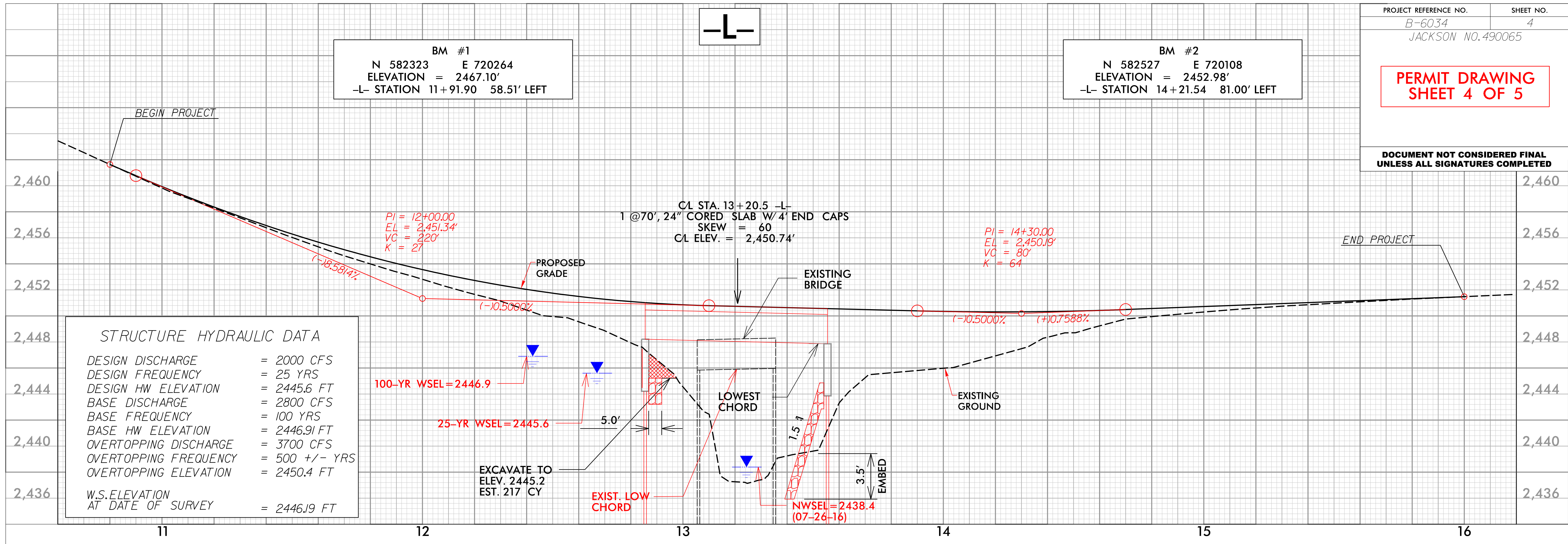

**PERMIT DRAWING  
SHEET 5 OF 5**

**DOCUMENT NOT CONSIDERED FINAL  
UNLESS ALL SIGNATURES COMPLETED**

| WETLAND PERMIT IMPACT SUMMARY |          |                       |                         |                                 |                                    |                             |                                |                             |                                |                                      |                                |                           |                              |                       |                          |   |                                     |                            |  |
|-------------------------------|----------|-----------------------|-------------------------|---------------------------------|------------------------------------|-----------------------------|--------------------------------|-----------------------------|--------------------------------|--------------------------------------|--------------------------------|---------------------------|------------------------------|-----------------------|--------------------------|---|-------------------------------------|----------------------------|--|
| Sheet No.                     | Site No. | Station (From/To)     | Structure Size / Type   | WETLAND IMPACTS                 |                                    |                             |                                |                             |                                |                                      |                                | SURFACE WATER IMPACTS     |                              |                       |                          |   |                                     |                            |  |
|                               |          |                       |                         | Permanent Fill In Wetlands (ac) | Permanent Fill In Wetlands (sq ft) | Temp. Fill In Wetlands (ac) | Temp. Fill In Wetlands (sq ft) | Excavation in Wetlands (ac) | Excavation in Wetlands (sq ft) | Mechanized Clearing in Wetlands (ac) | Hand Clearing in Wetlands (ac) | Permanent SW impacts (ac) | Permanent SW impacts (sq ft) | Temp. SW impacts (ac) | Temp. SW impacts (sq ft) | Existing Channel Impacts Permanent (ft) | Existing Channel Impacts Temp. (ft) | Natural Stream Design (ft) |  |
| 4                             | 1        | -L- 12+84 to 13+56 CL | 1 @ 70', 24" Cored Slab |                                 |                                    |                             |                                |                             |                                |                                      |                                |                           |                              |                       | 0.014                    | 596.00                                  |                                     |                            |  |
|                               |          |                       | Bank Stabilization      |                                 |                                    |                             |                                |                             |                                |                                      |                                |                           |                              |                       |                          |   | 53                                  |                            |  |
|                               |          |                       | Temporary Dewatering    |                                 |                                    |                             |                                |                             |                                |                                      |                                |                           |                              |                       |                          |   |                                     | 50                         |  |
|                               |          |                       |                         |                                 |                                    |                             |                                |                             |                                |                                      |                                |                           |                              |                       |                          |   |                                     |                            |  |
|                               |          |                       |                         |                                 |                                    |                             |                                |                             |                                |                                      |                                |                           |                              |                       |                          |   |                                     |                            |  |
| <b>SHEET TOTAL:</b>           |          |                       |                         |                                 |                                    |                             |                                |                             |                                |                                      |                                | 0                         | 0                            | 0.01                  | 596                      | 53                                      | 50                                  |                            |  |

Potential Clearing Limits = 8-10 Trees To Be Cleared

**DEPARTMENT OF THE ARMY  
Wilmington District, Corps of Engineers  
69 Darlington Avenue  
Wilmington, North Carolina 28403-1343**

**Regional General Permit No. SAW-2019-02350 (RGP 50)  
Name of Permittee: North Carolina Department of Transportation  
Effective Date: May 26, 2025  
Expiration Date: May 25, 2030**

**DEPARTMENT OF THE ARMY  
REGIONAL GENERAL PERMIT**

A regional general permit (RGP) to perform work in or affecting navigable waters of the United States and waters of the United States, upon recommendation of the Chief of Engineers, pursuant to Section 10 of the Rivers and Harbors Act of March 3, 1899 (33 U.S.C. 403), and Section 404 of the Clean Water Act (33 U.S.C. 1344), is hereby issued by authority of the Secretary of the Army by the

District Commander  
U.S. Army Engineer District, Wilmington  
Corps of Engineers  
69 Darlington Avenue  
Wilmington, North Carolina 28403-1343

**TO AUTHORIZE THE DISCHARGE OF DREDGED OR FILL MATERIAL IN WATERS OF THE UNITED STATES (U.S.), INCLUDING WETLANDS, ASSOCIATED WITH CERTAIN MAINTENANCE, REPAIR, AND CONSTRUCTION PROJECTS CONDUCTED BY THE VARIOUS DIVISIONS OF THE NORTH CAROLINA DEPARTMENT OF TRANSPORTATION (NCDOT), INCLUDING THE NCDOT DIVISION OF HIGHWAYS, RAIL, BICYCLE/PEDESTRIAN, ETC.**

Activities authorized by this RGP:

- a. (1) Road widening, and/or (2) construction, maintenance, replacement, and/or repair of bridges. For bridge projects, work can include the approaches.
- b. (1) Improvement of interchanges or intersections, or (2) construction of interchanges or intersections over, or on, existing roads.

**Full descriptions/terms of “a.” and “b.”:**

**a. (1) Road widening, and/or (2) construction, maintenance, and/or repair of bridges. For bridge projects, work can include the approaches.**

Permanent impacts that result in a loss of waters of the U.S., excluding stream relocation(s), must be less than or equal to 500 linear feet (lf) of stream and/or one (1) acre of wetland/open water for each single and complete linear project.

Single and complete linear project. As noted in 33 CFR 330.2(i), for linear projects, the “single and complete project” (i.e., single and complete crossing) will apply to each crossing of a separate water of the U.S. (i.e., single waterbody) at that location; except that for linear projects crossing a single waterbody several times at separate and distant locations, each crossing is considered a single and complete project. However, individual channels in a braided stream or river, or individual arms of a large, irregularly-shaped wetland or lake, etc., are not separate waterbodies and crossing of such features cannot be considered separately.

This RGP can be used for those projects where a bridge is replaced with a culvert if the U.S. Army Corps of Engineers (Corps) determines that (1) NCDOT has provided sufficient justification for replacing a bridge with a culvert and (2) NCDOT has adequately demonstrated that the bridge to culvert replacement project would have no more than minimal individual and cumulative adverse effects to the aquatic environment. Note that all comments from commenting and/or other permitting agencies would be considered in the Corps’ evaluation of a bridge to culvert project.

Activities authorized under “a.” may include a small amount of new location roadway provided that the Corps determines that NCDOT has sufficiently demonstrated that (1) the new location roadway is necessary for safety, access, or other compelling reasons and (2) the length of the new location roadway is minimal and would not change the nature of the project from a widening or bridge project under “a.” to a new location roadway project.

For road widening or bridge projects - to ensure that the Corps has the necessary information to evaluate proposed impacts and effects to waters of the U.S. for a specific transportation project prior to making a permit decision, NCDOT’s Preconstruction Notification (PCN) for a specific transportation project must include a description of all impacts to waters of the U.S. that would result from (1) the transportation facility itself AND (2) all other impacts to waters of the U.S. that would be caused by, or result from, construction of the transportation facility; this includes impacts to waters of the U.S. from any associated, non-transportation facilities, such as utility infrastructure, driveway relocations, etc. NCDOT shall also detail in the PCN whether or not another entity (i.e., other than NCDOT) will apply for those non-transportation facility impacts to waters of the

U.S. separately. If NCDOT will apply for both the transportation AND non-transportation facility impacts to waters of the U.S. for a specific project (or some but not all of the non-transportation facilities), NCDOT will provide the required information for both the transportation AND the non-transportation facility impacts in the project summary and the impact table sections of the PCN. In those situations where NCDOT applies for and receives authorization to impact waters of the U.S. for both the transportation facility AND the non-transportation facilities for a specific project (or some but not all of the non-transportation facilities), NCDOT will be the responsible party/permittee for all permit-related matters for those impacts to waters of the U.S. to include the responsibility for permit compliance and obtaining any required compensatory mitigation.

Also authorized under “a”: (1) stream relocation(s) and (2) temporary impacts, such as those from temporary structures, fills, dewatering, and other work necessary to conduct the activities listed under “a”. Stream relocation(s) and temporary impacts will be evaluated independently and are not limited to the permanent loss limits of 500 lf of stream and/or 1 acre of wetland/open water (i.e., stream relocations and/or temporary impacts do not factor into these limits) for each single and complete linear project; however, if the Corps determines that the proposed stream relocation(s) and/or temporary impacts are of such magnitude that they cannot be authorized under this section (“a”) of RGP 50, even if the permanent losses from road widening, and/or construction, maintenance, and repair of bridges do not exceed the impact limits for this section (“a”) of RGP 50, an Individual Permit will be required.

If the Corps determines, on a case-by-case basis, that the concerns for the aquatic environment so indicate, he/she may exercise discretionary authority to override this RGP and require an Individual Permit.

**b. (1) Improvement of interchanges or intersections, or (2) construction of interchanges or intersections, over or, on existing roads.**

For activities authorized under “b”, the limits for permanent impacts that result in a loss of waters of the U.S. depend on the location of the impacts, as described below:

- In the coastal plain of North Carolina (both inner coastal plain and outer coastal plain) - permanent impacts that result in a loss of waters of the U.S., excluding stream relocation(s), must be less than or equal to 1,000 lf of stream and/or 3 acres of wetland/open water for the entire interchange or intersection project.
- All other areas of North Carolina - permanent impacts that result in a loss of waters of the U.S., excluding stream relocation(s), must be less than or equal to 1,000 lf of stream and/or 2 acres of wetland/open water for the entire interchange or intersection project.

Coastal plain – See [http://saw-reg.usace.army.mil/JD/LRRs\\_PandT.pdf](http://saw-reg.usace.army.mil/JD/LRRs_PandT.pdf) for Land Resource Areas LRRP (inner coastal plain) and LRRT (outer coastal plain).

When proposed impacts to waters of the U.S. are located both inside AND outside of the coastal plain, the Corps will determine, based on the location(s) of proposed impacts to waters of the U.S., if a project is a “coastal plain project”.

Single and complete project. For permitting purposes, each interchange or intersection is considered to be one single and complete project. For example, an interchange project cannot result in a permanent loss (excluding stream relocation), of (1) greater than 1,000 lf of stream and/or 3 acres of wetland/open water in the coastal plain OR (2) greater than 1,000 lf of stream and/or 2 acres of wetland/open water in all other areas of North Carolina.

Approach fills may be considered to be part of an interchange or intersection project if the Corps determines that inclusion of these areas meet the terms of this section (“b”) of RGP 50. It is understood that approach fills may be on new location. Early coordination with the Corps is encouraged.

Intersections, regardless of the mode of transportation (e.g., railroad, other roadways, etc.), may be at grade or grade separated if the Corps determines that the project would meet the terms of this section (“b”) of RGP 50. Early coordination with the Corps is encouraged.

For interchange or intersection projects - to ensure that the Corps has the necessary information to evaluate proposed impacts and effects to waters of the U.S. for a specific transportation project prior to making a permit decision, NCDOT’s Preconstruction Notification (PCN) for a specific transportation project must include a description of all impacts to waters of the U.S. that would result from (1) the transportation facility itself AND (2) all other impacts to waters of the U.S. that would be caused by, or result from, construction of the transportation facility; this includes impacts to waters of the U.S. from any associated, non-transportation facilities, such as utility infrastructure, driveway relocations, etc. NCDOT shall also detail in the PCN whether or not another entity (i.e., other than NCDOT) will apply for those non-transportation facility impacts to waters of the U.S. separately. If NCDOT will apply for both the transportation AND non-transportation facility impacts to waters of the U.S. for a specific project (or some but not all of the non-transportation facilities), NCDOT will provide the required information for both the transportation AND the non-transportation facility impacts in the project summary and the impact table sections of the PCN. In those situations where NCDOT applies for and receives authorization to impact waters of the U.S. for both the transportation facility AND the non-transportation facilities for a specific project (or some but not all of the non-transportation facilities), NCDOT will be the responsible party/permittee for all permit-related matters for those impacts to waters of the U.S. to include the responsibility for permit compliance and obtaining any required compensatory mitigation.

Also authorized under “b”: (1) stream relocation(s) and (2) temporary impacts, such as those from temporary structures, fills, dewatering, and other work necessary to conduct the activities listed under “b”. Stream relocation(s) and temporary impacts will be evaluated independently and are not limited to the permanent loss limits of (1) 1,000 lf of

stream and/or 3 acres of wetland/open water in the coastal plain OR (2) 1,000 lf of stream and/or 2 acres of wetland/open water in all other areas of North Carolina (i.e., stream relocations and/or temporary impacts do not factor into these limits) for each interchange or intersection project; however, if the Corps determines that the proposed stream relocation(s) and/or temporary impacts are of such magnitude that they cannot be authorized under this section (“b”) of RGP 50, even if the permanent losses from improvement of interchanges or intersections, or construction of interchanges or intersections over, or on, existing roads do not exceed the impact limits for this section (“b”) of RGP 50, an Individual Permit will be required.

If the Corps determines, on a case-by-case basis, that the concerns for the aquatic environment so indicate, he/she may exercise discretionary authority to override this RGP and require an Individual Permit.

## **1. Special Conditions**

a. The prospective permittee must submit a pre-construction notification (PCN) and applicable supporting information to the District Engineer and receive written verification from the Corps that the proposed work complies with this RGP prior to commencing any activity authorized by this RGP.

b. If the project will not impact a designated “Area of Environmental Concern” (AEC) in the twenty\* (20) counties of North Carolina covered by the North Carolina Coastal Area Management Act (CAMA) (“CAMA counties”), a consistency submission is not required. If the project will impact a designated AEC and meets the definition of “development”, the prospective permittee must obtain the required CAMA permit. Development activities shall not commence until a copy of the approved CAMA permit is furnished to the appropriate Corps Regulatory Field Office (Wilmington Field Office – 69 Darlington Avenue, Wilmington, NC 28403 or Washington Field Office – 2407 West 5th Street, Washington, NC 27889).

**\*The 20 CAMA counties in North Carolina include Beaufort, Bertie, Brunswick, Camden, Carteret, Chowan, Craven, Currituck, Dare, Gates, Hertford, Hyde, New Hanover, Onslow, Pamlico, Pasquotank, Pender, Perquimans, Tyrrell, and Washington.**

c. No work shall be authorized by this RGP within the 20\* CAMA counties without prior consultation with the National Oceanic and Atmospheric Administration’s (NOAA) Habitat Conservation Division. For each activity reviewed by the Corps where it is determined that the activity may affect Essential Fish Habitat (EFH) for federally managed species, an EFH Assessment shall be prepared by the prospective permittee and forwarded to the Corps and NOAA Fisheries for review and comment prior to authorization of work.

d. Culverts and pipes. The following conditions [(1)-(8)] apply to the construction of culverts/pipes, and work on existing culverts/pipes.

Additionally, if the proposed work would affect an existing culvert/pipe (e.g., culvert/pipe extensions), the prospective permittee must include actions (in the PCN) to correct any existing deficiencies that are located:

- At the inlet and/or outlet of the existing culvert/pipe, IF these deficiencies are/were caused by the existing culvert/pipe, or
- Near the inlet or outlet of the existing culvert/pipe, IF these deficiencies are/were caused by the existing culvert/pipe.

These deficiencies may include, but are not limited to, stream over-widening, bank erosion, streambed scour, perched culvert/pipes, and inadequate water depth in culvert(s). Also note if the proposed work would address the existing deficiency or eliminate it – e.g., bank erosion on left bank, but the culvert extension will be placed in this eroded area. If the prospective permittee is unable to correct the deficiencies caused by the existing culvert/pipe, they must document the reasons in the PCN for Corps consideration.

(1) No activity may result in substantial, permanent disruption of the movement of those species of aquatic life indigenous to the waterbody, including those species that normally migrate through the area. Measures will be included that will promote the safe passage of fish and other aquatic organisms.

(2) The dimension, pattern, and profile of the stream above and below a culvert/pipe shall not be modified by widening the stream channel or by reducing the depth of the stream in connection with the construction activity. It is acceptable to use rock vanes at culvert/pipe outlets to ensure, enhance, or maintain aquatic passage. Pre-formed scour holes are acceptable when designed for velocity reduction. The width, height, and gradient of a proposed opening shall be such as to pass the average historical low flow and spring flow without adversely altering flow velocity. Spring flow will be determined from gauge data, if available. In the absence of such data, bankfull flow will be used as a comparable level.

(3) Burial/depth specifications: If the project is located within any of the 20\* CAMA counties, culvert/pipe inverts will be buried at least one foot below normal bed elevation when they are placed within the Public Trust AEC and/or the Estuarine Waters AEC as designated by CAMA. If the project is located outside of the 20\* CAMA counties, culvert/pipe inverts will be buried at least one foot below the bed of the stream for culverts/pipes that are greater than 48 inches in diameter. Culverts/pipes that are 48 inches in diameter or less shall be buried or placed on the stream bed as practicable and appropriate to maintain aquatic passage, to include passage during

drought or low flow conditions. Every effort shall be made to maintain the existing channel slope. A waiver from the burial/depth specifications in this condition may be requested in writing. The prospective permittee is encouraged to request agency input about waiver requests as early as possible, and prior to submitting the PCN for a specific project; this will allow the agencies time to conduct a site visit, if necessary, and will prevent time delays and potential project revisions for the prospective permittee. The waiver will only be issued by the Corps if it can be demonstrated that the impacts of complying with burial requirements would result in more adverse impacts to the aquatic environment.

(4) Appropriate actions to prevent destabilization of the channel and head cutting upstream shall be incorporated in the design and placement of culverts/pipes.

(5) Culverts/pipes placed within riparian and/or riverine wetlands must be installed in a manner that does not restrict the flow and circulation patterns of waters of the U.S. Culverts/pipes placed across wetland fills purely for the purposes of equalizing surface water do not have to be buried but must be of adequate size and/or number to ensure unrestricted transmission of water.

(6) Bankfull flows (or less) shall be accommodated through maintenance of the existing bankfull channel cross sectional area in no more than one culvert/pipe or culvert/pipe barrel. Additional culverts/pipes or barrels at such crossings shall be allowed only to receive flows exceeding the bankfull flow. A waiver from this condition may be requested in writing; this request must be specific as to the reason(s) for the request. The waiver will be issued if it can be demonstrated that it is not practicable to comply with this condition.

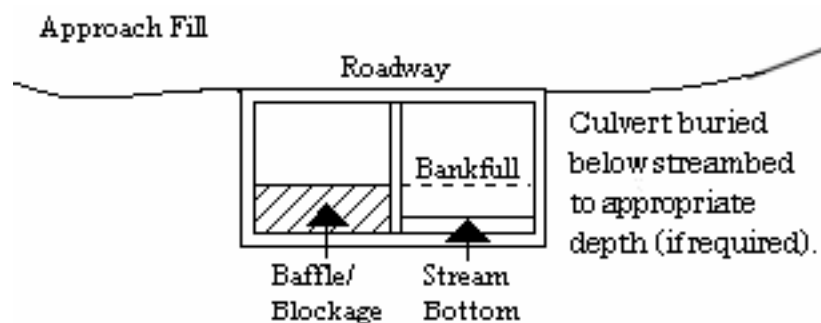

(7) Where adjacent floodplain is available, flows exceeding bankfull will be accommodated by installing culverts/pipes at the floodplain elevation. When multiple culverts/pipes are used, baseflow must be maintained at the appropriate width and depth by the construction of floodplain benches, sills, and/or construction methods to ensure that the overflow culvert(s)/pipe(s) is elevated above the baseflow culvert(s)/pipe(s).

(8) The width of the baseflow culvert/pipe shall be comparable to the width of the bankfull width of the stream channel. If the width of the baseflow culvert/pipe is wider than the stream channel, the culvert/pipe shall include baffles, benches and/or sills to maintain the width of the stream channel. A waiver from this condition may be requested in writing; this request must be specific as to the reason(s) for the request. The waiver will be issued if it can be demonstrated that it is not practicable or necessary to include baffles, benches or sills.

See the remaining special conditions for additional information about culverts/pipes in specific areas.

e. Discharges into waters of the U.S. designated by either the North Carolina Division of Marine Fisheries (NCDMF) or the North Carolina Wildlife Resources Commission (NCWRC) as anadromous fish spawning areas are prohibited during the period between February 15th and June 30th, without prior written approval from the Corps and the appropriate wildlife agencies (NCDMF, NCWRC, and/or the National Marine Fisheries Service (NMFS)). Discharges into waters of the U.S. designated by NCWRC as primary nursery areas in inland waters are prohibited during the period between February 15th and September 30th, without prior written approval from the Corps and the appropriate wildlife agencies. Discharges into waters of the U.S. designated by NCDMF as primary nursery areas shall be coordinated with NCDMF prior to being authorized by this RGP. Coordination with NCDMF may result in a required construction moratorium during periods of significant biological productivity or critical life stages.

The prospective permittee should contact:

|  |  |  |  |
|--|--|--|--|
| <b>NC Division of Marine Fisheries</b> |  | <b>North Carolina Wildlife Resources</b> |  |
| <b>Commission</b>                      |  |  |  |
| <b>3441 Arendell Street</b>            |  | <b>Habitat Conservation Division</b>     |  |
| <b>Morehead City, NC 28557</b>         |  | <b>1721 Mail Service</b>                 |  |
| <b>Center Telephone 252-726-7021</b>   |  | <b>Raleigh, NC</b>                       |  |
| <b>27699-1721 or 800-682-2632</b>      |  | <b>Telephone (919) 707-</b>              |  |
| <b>0220</b>                            |  |  |  |

f. This permit does not authorize the use of culverts in areas designated as anadromous fish spawning areas by the NCDMF or the NCWRC.

g. No in-water work shall be conducted in Waters of the U.S. designated as Atlantic sturgeon critical habitat during the periods between February 1st and June 30th. No in-water work shall be conducted in Waters of the U.S. in the Roanoke River designated as Atlantic sturgeon critical habitat during the periods between February 1st and June 30th, and between August 1st to October 31st, without prior written approval from NMFS.

h. Before discharging dredged or fill material into waters of the U.S. in designated trout watersheds in North Carolina, the PCN will be sent to the NCWRC and the Corps concurrently. See <https://www.saw.usace.army.mil/Missions/Regulatory-Permit-Program/Agency-Coordination/Trout.aspx> for the designated trout watersheds. The PCN shall summarize alternatives to conducting work in waters of the U.S. in trout watersheds that were considered during the planning process and detail why alternatives were or were not selected. For proposals where (1) a bridge in a trout stream will be replaced with a culvert, or (2) a culvert will be placed in a trout stream, the PCN must also include a compensatory mitigation plan for all loss of stream bed, and details of any on-site evaluations that were conducted to determine that installation of a culvert will not adversely affect passage of fish or other aquatic biota at the project site. The evaluation information must include factors such as the proposed slope of the culvert and determinations of how the slope will be expected to allow or impede passage, the necessity of baffles and/or sills to ensure passage, design considerations to ensure that expected baseflow will be maintained for passage and that post-construction velocities will not prevent passage, site conditions that will or will not allow proper burial of the culvert, existing structures (e.g., perched culverts, waterfalls, etc.) and/or stream patterns up and downstream of the culvert site that could affect passage and bank stability, and any other considerations regarding passage. The level of detail for this information shall be based on site conditions (i.e., culverts on a slope over 3% will most likely require more information than culverts on a slope that is less than 1%, etc.). Also, in order to evaluate potential impacts, the prospective permittee will describe bedforms that will be impacted by the proposed culvert – e.g., pools, glides, riffles, etc. The NCWRC will respond to both the prospective permittee and the Corps.

i. For all activities authorized by this RGP that involve the use of riprap material for bank stabilization, the following measures shall be applied:

(1) Filter cloth must be placed underneath the riprap as an additional requirement of its use in North Carolina waters; however, the prospective permittee may request a waiver from this requirement. The waiver request must be in writing. The Corps will only issue a waiver if the prospective permittee demonstrates that the impacts of complying with this requirement would result in greater adverse impacts to the aquatic environment. Note that filter fabric is not required if the riprap will be pushed or “keyed” into the bank of the waterbody.

(2) Rip rap shall be placed only on the stream banks, or, if it is necessary to be placed in the stream bed, the finished top elevation of the rip rap shall not exceed that of the original stream bed.

(3) The placement of riprap shall be limited to the areas depicted on submitted work plan drawings.

(4) Riprap shall not be placed in a manner that prevents or impedes fish

passage.

(5) Riprap shall be clean and free from loose dirt or any pollutant except in trace quantities that will not have an adverse environmental effect.

(6) Riprap shall be of a size sufficient to prevent its movement from the authorized alignment by natural forces under normal conditions.

(7) Riprap material shall consist of clean rock or masonry material such as, but not limited to, granite, marl, or broken concrete.

j. Discharges of dredged or fill material into waters of the U.S., including wetlands, must be minimized or avoided to the maximum extent practicable.

k. Generally, off-site detours are preferred to avoid and minimize impacts to the human and natural environment; however, if an off-site detour is considered impracticable, then an on-site detour may be considered as a necessary component of the actions authorized by this RGP. Impacts from the detour may be considered temporary and may not require compensatory mitigation if the impacted area is restored to pre-construction elevations and contours after construction is complete. The permittee shall also restore natural hydrology and stream corridors (if applicable), and reestablish native vegetation/riparian corridors. If the construction of a detour (on-site or off-site) includes standard undercutting methods, removal of all material and backfilling with suitable material is required. See special condition "s" for additional information.

l. All activities authorized by this RGP shall, to the maximum extent practicable, be conducted "in the dry", with barriers installed between work areas and aquatic habitat to protect that habitat from sediment, concrete, and other pollutants. Where concrete is utilized, measures will be taken to prevent live or fresh concrete, including bags of uncured concrete, from coming into contact with waters of the U.S. until the concrete has set and cured. All water in the work area that has been in contact with concrete shall only be returned to waters of the U.S. when it no longer poses a threat to aquatic organisms (concrete is set and cured).

m. In cases where new alignment approaches are to be constructed and the existing approach fill in waters of the U.S. is to be abandoned and no longer maintained as a roadway, the abandoned fill shall be removed and the area will be restored to pre-construction elevations and contours. The permittee shall also restore natural hydrology and stream corridors (if applicable), and reestablish native vegetation/riparian corridors, to the extent practicable. This activity may qualify as compensatory mitigation credit for the project and will be assessed on a case-by-case basis in accordance with Special Conditions "q" and "r" in this document. Any proposed on-site wetland restoration area must be void of utility conflicts and/or utility maintenance areas. A restoration plan detailing this activity will be required with the submittal of the PCN.

n. To the maximum extent practicable, the pre-construction course, condition, capacity, and location of open waters must be maintained for each activity, including stream channelization and storm water management activities, except as provided below. The activity must be constructed to withstand expected high flows. The activity must not restrict or impede the passage of normal or high flows, unless the primary purpose of the activity is to impound water or manage high flows. The activity may alter the pre-construction course, condition, capacity, and location of open waters if it benefits the aquatic environment (e.g., stream restoration or relocation activities).

o. The project must be implemented and/or conducted so that all reasonable and practicable measures to ensure that equipment, structures, fill pads, and work associated with the project do not adversely affect upstream and/or downstream reaches. Adverse effects include, but are not limited to, channel instability, scour, flooding, and/or shoreline/streambank erosion. During construction, the permittee shall routinely monitor for these effects, cease all work if/when detected, take initial corrective measures to correct actively eroding areas, and notify the Corps immediately. Permanent corrective measures may require additional authorization from the Corps.

p. All PCNs will describe sedimentation and erosion control structures and measures proposed for placement in waters of the U.S. To the maximum extent practicable, structures and measures will be depicted on maps, surveys or drawings showing location and impacts to jurisdictional wetlands and streams. In addition, appropriate soil and erosion control measures must be established and maintained during construction. All fills, temporary and permanent, must be adequately stabilized at the earliest practicable date to prevent erosion of fill material into adjacent waters or wetlands.

q. Compensatory mitigation will be required for permanent impacts resulting in a loss of waters of the U.S. due to culvert/pipe installation and other similar activities. Mitigation may be required for stream relocation projects (see Special Condition "r" below). When compensatory mitigation is required, the prospective permittee will attach a proposed mitigation plan to the PCN. Compensatory mitigation proposals will be written in accordance with currently approved Wilmington District guidance and Corps mitigation regulations, unless the purchase of mitigation credits from an approved mitigation bank or the North Carolina Division of Mitigation Services (NCDMS) is proposed to address all compensatory mitigation requirements. The Corps Project Manager will make the final determination concerning the appropriate amount and type of mitigation.

r. Stream Relocations (non-tidal only). Stream relocation is when a stream is moved laterally to a new location to allow a project, or part of a project, to be constructed in the stream's former location. For permitting purposes, stream relocations are considered a loss of waters of the U.S. The new/relocated stream itself may reduce the

amount of compensatory mitigation that is required for a specific stream relocation activity. Depending on the condition and location of (1) the existing stream, and (2) the relocated stream, the relocated stream may provide a functional uplift of overall stream function. The Corps will determine if an uplift is possible based on the information submitted with the PCN. If the anticipated uplift(s) occurs, it may offset, either partially or fully, the loss associated with a stream relocation(s) - i.e., due to the uplift, either no compensatory mitigation would be required for the stream relocation itself, or compensatory mitigation would be required at a reduced ratio.

Because the amount of potential uplift is, in part, dependent upon the condition (or quality) of the channel to be relocated, there is no pre-determined amount of uplift needed to satisfy the requirements for a successful relocation project. After performing the evaluation(s) noted in this document, the prospective permittee will propose a certain amount of uplift potential and the Corps project manager will make the final determination. Baseline conditions and subsequent monitoring must show that the relocated channel is providing/will provide aquatic function at, or above, the level provided by the baseline (pre-project) condition. If the required uplift is not achieved, the work will not be in compliance with this special condition of RGP 50 and remediation will be required through repair (and continued monitoring), or by the permittee providing compensatory mitigation (e.g., mitigation credit through an approved bank, mitigation credit through NCDMS, etc.).

Compensatory mitigation, in addition to the stream relocation activity, may be required if the Corps determines that (a) no uplift in stream function is achievable, (b) the proposed uplift in stream function is not sufficient, by itself, (c) the risks associated with achieving potential uplifts in stream function are excessive, and/or (d) the time period for achieving the potential uplifts/functional success is too great.

On-site compensatory mitigation is not the same as stream relocation. While stream relocation simply moves a stream to a nearby, geographically similar area, it does not generate mitigation credits. If NCDOT proposes to generate compensatory mitigation on a project site, NCDOT must submit a mitigation plan that complies with 33 CFR 332.4.

**The prospective permittee is required to submit the following information for any proposed project that involves stream relocation, regardless of the size/length of the stream relocation** (note that 1-5 below only apply to stream relocations and not to compensatory mitigation):

- (1) A statement detailing why relocating the stream is unavoidable. In order to ensure that this action is separate from a compensatory mitigation project, the need for the fill must be related to road/interchange/intersection construction or improvement, and the project must meet the requirements set forth in the full descriptions/terms of “a” and “b” on pages 2 and 3 of this permit.

- (2) An evaluation of effects on the relocated stream and buffer from utilities, or potential for impact from utility placement in the future.
- (3) An evaluation of the baseline condition of the stream to be relocated. In order to demonstrate a potential uplift, the prospective permittee must provide the baseline (pre-impact) condition of the stream that is proposed for relocation. The prospective permittee will document the baseline condition of the stream by using the Corps' (Wilmington District's) current functional assessment method - e.g., the North Carolina Stream Assessment Method (NCSAM). The functional assessment must be used to identify specific areas where an uplift would reasonably be expected to occur, and also show important baseline functions that will remain after the relocation.
- (4) An evaluation of the potential uplifts to stream function for the relocated channel. The amount of detail required in the plan will be commensurate with the functional capacity of the original stream and proposed uplift(s). Low functional capacity will warrant less monitoring and less detail in the plan in order to ensure that the relocated channel provides the same, or better/increased, suite of aquatic functions as the existing channel.

Note that to either reduce or eliminate the need to provide compensatory mitigation for stream relocation impacts, the bed of the relocated stream should not be hardened or stabilized, to include embedded rip rap; note that grade control structures are acceptable. Additionally, the relocated channel should have similar or better pattern, profile, and dimension than the existing channel. Finally, the banks of the relocated channel should not be hardened, although limited stabilization may be acceptable if NCDOT adequately demonstrates why this is necessary.

- (5) A proposed monitoring plan for the relocated channel (and buffer, if applicable), will be prepared in accordance with current District guidance. The level of detail needed in the plan will be directly related to the quality of baseline functions and the anticipated uplift, therefore it is recommended that a pre-application discussion occur with the Corps Project Manager as early as possible. For example, if the risk for achieving the anticipated functional uplift is moderate or low, or if there is a low amount of proposed uplift, less information and monitoring will be required in the proposed relocation plan; similar to the requirements found in the "2003 Stream Mitigation Guidelines". If the risk for uplift is higher, or if there is a high amount of proposed uplift, additional monitoring and information will be required, trending toward the prescriptions found in the most recent Wilmington District Compensatory Mitigation Guidance – e.g., the 2016 Wilmington District Stream and Wetland Compensatory Mitigation Update. All monitoring will be for at least 5 years unless the Corps project manager determines that (a) a specific project requires less than 5 years

due to site conditions or limited risk/uplift potential, and/or complexity (or simplicity) of the existing channel and/or the relocation work, or (b) the Corps project manager determines (during the monitoring period) that the 5 years of monitoring may be reduced (or that no further monitoring is required) based on monitoring information received once the stream relocation has been completed.

s. Upon completion of any work authorized by this RGP, all temporary fills (to include culverts, pipes, causeways, etc.) will be completely removed from waters of the U.S. and the areas will be restored to pre-construction elevations and contours. The permittee shall also restore natural hydrology and stream corridors (if applicable) and reestablish native vegetation/riparian corridors. This work will be completed within 60 days of completion of project construction. If this timeframe occurs while a required moratorium of this permit is in effect, the temporary fill shall be removed in its entirety within 60 days of the moratorium end date. If vegetation cannot be planted due to the time of the year, all disturbed areas will be seeded with a native mix appropriate for the impacted area, and vegetation will be planted during the next appropriate time frame. A native seed mix may contain non-invasive small grain annuals (e.g. millet and rye grain) to ensure adequate cover while native vegetation becomes established. The PCN must include a restoration plan showing how all temporary fills and structures will be removed and how the area will be restored to pre-project elevations and contours.

t. Borrow and Waste Activities. For those projects that involve borrow and/or waste activities (note that if the borrow or waste area is also used for purposes/clients other than NCDOT, this condition will not apply to an NCDOT project) - To ensure that all borrow and waste activities occur on high ground and do not result in the degradation of adjacent waters and wetlands, except as authorized by the RGP verification letter issued for a specific project, the permittee shall require its contractors and/or agents to identify all areas to be used as borrow and/or waste sites associated with an authorized project. The permittee shall provide the Corps with appropriate maps indicating the locations of proposed borrow and/or waste sites as soon as such information is available. The permittee shall submit to the Corps site-specific information needed to ensure that borrow and/or waste sites comply with all applicable Federal requirements, to include compliance with the Endangered Species Act and the National Historic Preservation Act, such as surveys or correspondence with agencies (e.g., the USFWS, the NC HPO, etc.). The required information shall also include the location of all aquatic features, if any, out to a distance of 400 feet beyond the nearest boundary of the site. The permittee shall not approve any borrow and/or waste sites before receiving written confirmation from the Corps that the proposed site meets all Federal requirements, whether or not waters of the U.S., including wetlands, are located in the proposed borrow and/or waste site. All delineations of aquatic sites on borrow and/or waste sites shall be verified by the Corps and shown on the approved reclamation plans. The permittee shall ensure that all borrow and/or waste sites comply with the following: Except as authorized by this permit or any

Corps approved modification to this permit, no excavation, fill, or mechanized land-clearing activities shall take place at any time in the construction or maintenance of this project, within waters or wetlands, or shall any activities take place that cause the degradation of waters or wetlands. There shall be no excavation from, waste disposal into, or degradation of, jurisdictional wetlands or waters associated with this permit without appropriate modification of this permit, including appropriate compensatory mitigation. This prohibition applies to all borrow and waste activities connected with this project. Additionally, the permittee shall produce and maintain documentation of all borrow and waste sites associated with this project. This documentation will include data regarding soils, vegetation, hydrology, any delineation(s) of aquatic sites, and any jurisdictional determinations made by the Corps. All information will be available to the Corps upon request. The permittee shall require its contractors to complete and execute reclamation plans for each borrow and/or waste site and provide written documentation that the reclamation plans have been implemented and all work is completed. This documentation will be provided to the Corps within 30 days of the completion of the reclamation work.

u. Once the authorized work in waters of the U.S. is complete, the permittee shall sign and return the compliance certificate that is attached to the RGP verification letter.

v. The District Engineer will consider any comments from Federal and/or State agencies concerning the proposed activity's compliance with the terms and conditions of this RGP.

w. The Corps may place additional special conditions, limitations, or restrictions on any verification of the use of RGP 50 on a project-by-project basis.

## **2. General Conditions**

a. The permittee shall ensure that the construction design plans do not deviate from the permit plans referenced in the RGP verification letter issued for a specific project. Any modification to the permit plans referenced in the RGP verification letter for a specific project must be approved by the Corps prior to any active construction in waters or wetlands.

b. Except as authorized by an RGP verification letter issued for a specific project and the supporting plans referenced in that verification letter, or any Corps approved modification to an RGP verification letter for a specific project, no excavation, fill or mechanized land-clearing activities shall take place within waters or wetlands, at any time during construction or maintenance of the project. This permit does not authorize temporary placement or double handling of excavated or fill material within waters or wetlands outside the permitted area. This prohibition applies to all borrow and fill activities connected with the project.

c. The permittee shall require its contractors and/or agents to comply with (1) the terms and conditions of this permit and (2) all conditions in the RGP verification letter for that project. The permittee shall provide each of its contractors and/or agents associated with the construction or maintenance of a specific project with a copy of this permit and the RGP verification letter. A copy of this permit and the RGP verification letter, including all conditions, drawings/plans and attachments shall be available at the project site during the construction and maintenance of any project authorized by an RGP verification letter.

d. During the clearing phase of the project, heavy equipment shall not be operated in surface waters or stream channels. Temporary stream crossings will be used to access the opposite sides of stream channels. All temporary diversion channels and stream crossings will be constructed of non-erodible materials. Grubbing of riparian vegetation will not occur until immediately before construction begins on a given segment of stream channel.

e. All mechanized equipment shall be regularly inspected and maintained to prevent contamination of waters and wetlands from fuels, lubricants, hydraulic fluids, or other toxic materials. In the event of a spill of petroleum products or any other hazardous waste, the permittee shall immediately report it to the N.C. Division of Water Resources at (919) 733-3300 or (800) 858-0368 and provisions of the North Carolina Oil Pollution and Hazardous Substances Control Act shall be followed.

f. Authorization under this RGP does not obviate the need to obtain other federal, state, or local authorizations.

g. All work authorized by this RGP must comply with the terms and conditions of the applicable CWA Section 401 Water Quality Certification for this RGP issued by the North Carolina Division of Water Resources (NCDWR).

h. The permittee shall employ all sedimentation and erosion control measures necessary to prevent an increase in sedimentation or turbidity within waters and wetlands outside of the permit area. This shall include, but is not limited to, the immediate installation of silt fencing or similar appropriate devices around all areas subject to soil disturbance or the movement of earthen fill, and the immediate stabilization of all disturbed areas. Additionally, the project must remain in full compliance with all aspects of the Sedimentation Pollution Control Act of 1973 (North Carolina General Statutes Chapter 113A Article 4).

i. The permittee shall remove all sediment and erosion control measures placed in waters and/or wetlands, and shall restore natural grades on those areas, prior to project completion.

j. The activities authorized by this RGP must not interfere with the public's right to free navigation on all navigable waters of the U.S. No attempt will be made by the

permittee to prevent the full and free use by the public of all navigable waters at, or adjacent to, the authorized work for a reason other than safety.

k. The permittee understands and agrees that if future operations by the U.S. require the removal, relocation, or other alteration, of the structure or work herein authorized, or if, in the opinion of the Secretary of the Army or his authorized representative, said structure or work shall cause unreasonable obstruction to the free navigation of the navigable waters, the permittee will be required, upon due notice from the Corps, to remove, relocate, or alter the structural work or obstructions caused thereby, without expense to the U.S. No claim shall be made against the U.S. on account of any such removal or alteration.

l. The permittee, upon receipt of a notice of revocation of this RGP for the verified individual activity, may apply for an individual permit, or will, without expense to the U.S. and in such time and manner as the Secretary of the Army or his/her authorized representative may direct, restore the affected water of the U.S. to its former conditions.

m. This RGP does not authorize any activity that would conflict with a federal project's congressionally authorized purposes, established limitations or restrictions, or limit an agency's ability to conduct necessary operation and maintenance functions. Per Section 14 of the Rivers and Harbors Act of 1899, as amended (33 U.S.C. 408), no project that has the potential to take possession of or make use of for any purpose, or build upon, alter, deface, destroy, move, injure, or obstruct a federally constructed work or project, including, but not limited to, levees, dams, jetties, navigation channels, borrow areas, dredged material disposal sites, flood control projects, etc., shall be permitted unless the project has been reviewed and approved by the appropriate Corps approval authority. Permittees shall not begin the activity authorized by this RGP until notified by the Corps that the activity may proceed.

n. The permittee shall obtain a Consent to Cross Government Easement from the appropriate Corps District's Land Use Coordinator prior to any crossing of a Corps easement and/or prior to commencing construction of any structures, authorized dredging, or other work within the right-of-way of, or in proximity to, a federally designated disposal area.

o. Federal Navigation Channel Setbacks. Authorized structures and fills located in or adjacent to Federally authorized waterways must be constructed in accordance with the latest setback criteria established by the Wilmington District Engineer. You may review the setback policy at <http://www.saw.usace.army.mil/Missions/Navigation/Setbacks.aspx>. This RGP permit does not authorize the construction of hardened or permanently fixed structures within the Federally Authorized Channel Setback, unless the activity is approved by the Corps.

p. The permittee will allow the Wilmington District Engineer or his/her representative to inspect the authorized activity at any time deemed necessary to ensure that the activity is being performed or maintained in strict accordance with the Special and General Conditions of this permit.

q. This RGP does not grant any property rights or exclusive privileges.

r. This RGP does not authorize any injury to the property or rights of others.

s. This RGP does not authorize the interference with any existing or proposed federal project.

t. In issuing this permit, the Federal Government does not assume any liability for the following:

(1) Damages to the permitted project or uses thereof as a result of other permitted or unpermitted activities or from natural causes.

(2) Damages to the permitted project or uses thereof as a result of current or future activities undertaken by or on behalf of the U.S. in the public interest.

(3) Damages to persons, property, or to other permitted or unpermitted activities or structures caused by the activity authorized by this permit.

(4) Design or construction deficiencies associated with the permitted work.

(5) Damage claims associated with any future modification, suspension, or revocation of this permit.

u. Authorization provided by this RGP may be modified, suspended or revoked in whole, or in part, if the Wilmington District Engineer, acting for the Secretary of the Army, determines that such action would be in the best public interest. The term of this RGP shall be five (5) years unless subject to modification, suspension, or revocation. Any modification, suspension, or revocation of this authorization will not be the basis for any claim for damages against the U.S. Government.

v. No activity may occur in a component of the National Wild and Scenic Rivers System, or in a river officially designated by Congress as a "study river" for possible inclusion in the system while the river is in an official study status, unless the appropriate Federal agency with direct management responsibility for such river, has determined in writing that the proposed activity will not adversely affect the Wild and Scenic designation

or study status. Information on Wild and Scenic Rivers may be obtained from the appropriate Federal land management agency responsible for the designated Wild and Scenic River or “study river” (e.g., National Park Service, U.S. Forest Service, etc.).

w. Endangered Species

(1) No activity is authorized under this RGP which is likely to directly or indirectly jeopardize the continued existence of a threatened or endangered species or a species proposed for such designation, as identified under the Federal Endangered Species Act (ESA), or which will directly or indirectly destroy or adversely modify the critical habitat of such species. No activity is authorized under this RGP which “may affect” a listed species or critical habitat, unless Section 7 consultation addressing the effects of the proposed activity has been completed.

(2) Federal agencies should follow their own procedures for complying with the requirements of the ESA. Federal prospective permittees (and when FHWA is the lead federal agency) must provide the District Engineer with the appropriate documentation to demonstrate compliance with those requirements. The District Engineer will review the documentation and determine whether it is sufficient to address ESA compliance for the RGP activity, or whether additional ESA consultation is necessary.

(3) Non-federal prospective permittees - for activities that might affect federally listed endangered or threatened species or designated critical habitat, the PCN must include the name(s) of the endangered or threatened species that might be affected by the proposed work or that utilize the designated critical habitat that might be affected by the proposed work. The District Engineer will determine whether the proposed activity “may affect” or will have “no effect” to listed species and designated critical habitat. In cases where the non-federal prospective permittee has identified listed species or critical habitat that might be affected or is in the vicinity of the project, and has so notified the Corps, the prospective permittee shall not begin work until the Corps has provided notification that the proposed activities will have “no effect” on listed species or critical habitat, or until Section 7 consultation has been completed.

(4) As a result of formal or informal consultation with the U.S. Fish and Wildlife Service (USFWS) or NMFS, the District Engineer may add species-specific endangered species conditions to the RGP verification letter for a project.

(5) Authorization of an activity by a RGP does not authorize the “take” of a threatened or endangered species as defined under the ESA. In the absence of separate authorization (e.g., an ESA Section 10 Permit, a Biological Opinion with “incidental take” provisions, etc.) from the USFWS or the NMFS, the ESA prohibits any person subject to the jurisdiction of the U.S. to take a listed species, where “take” means to harass, harm, pursue, hunt, shoot, wound, kill, trap, capture, or collect, or to attempt to engage in any

such conduct. The word “harm” in the definition of “take” means an act which actually kills or injures wildlife. Such an act may include significant habitat modification or degradation where it actually kills or injures wildlife by significantly impairing essential behavioral patterns, including breeding, feeding or sheltering.

(6) Information on the location of threatened and endangered species and their critical habitat can be obtained directly from the offices of the USFWS in North Carolina at the addresses provided below, or from the USFWS and NMFS via their world wide web pages at <http://www.fws.gov/> or <http://www.fws.gov/ipac> and <http://www.noaa.gov/fisheries.html> respectively.

USFWS offices in North Carolina:

The Asheville USFWS Office covers all NC counties west of, and including, Anson, Stanly, Davidson, Forsyth and Stokes Counties.

US Fish and Wildlife Service  
Asheville Field Office  
160 Zillicoa Street  
Asheville, NC 28801  
Telephone: (828) 258-3939

The Raleigh USFWS Office covers all NC counties east of, and including, Richmond, Montgomery, Randolph, Guilford, and Rockingham Counties.

US Fish and Wildlife Service  
Raleigh Field Office  
Post Office Box 33726  
Raleigh, NC 27636-3726  
Telephone: (919) 856-4520

x. The Wilmington District, USFWS, NCDOT, and the FHWA have conducted programmatic Section 7(a)(2) consultation for a number of federally listed species and habitat, and programmatic consultation concerning other federally listed species and/or habitat may occur in the future. The result of completed programmatic consultation is a Programmatic Biological Opinion (PBO) issued by the USFWS. These PBOs contain mandatory terms and conditions to implement the reasonable and prudent measures that are associated with “incidental take” of whichever species or critical habitat is covered by a specific PBO. Authorization under RGP 50 is conditional upon the permittee’s compliance with all the mandatory terms and conditions associated with incidental take of the applicable PBO (or PBOs), which are incorporated by reference in RGP 50. Failure to comply with the terms and conditions associated with incidental take of an applicable PBO, where a take of the federally listed species occurs, would constitute an unauthorized take by the permittee, and would also constitute permittee non-compliance with the authorization under RGP 50. If the terms and conditions of a specific PBO (or PBOs)

apply to a project, the Corps will include this/these requirements in any RGP 50 verification that may be issued for a project. The USFWS is the appropriate authority to determine compliance with the terms and conditions of its PBO, and with the ESA.

y. For proposed activities the sixteen (16) counties listed below, prospective permittees must provide a copy of the PCN to the USFWS, 160 Zillicoa Street, Asheville, North Carolina 28801. This PCN must be sent concurrently to the USFWS and the Corps Project Manager for that specific county.

The 16 counties with tributaries that drain to designated critical habitat that require notification to the Asheville USFWS are: Avery, Cherokee, Forsyth, Graham, Haywood, Henderson, Jackson, Macon Mecklenburg, Mitchell, Stokes, Surry, Swain, Transylvania, Union and Yancey.

z. If the permittee discovers or observes any live, damaged, injured or dead individual of an endangered or threatened species during construction, the permittee shall immediately notify the Wilmington District Engineer so that required coordination can be initiated with the U.S. Fish and Wildlife Service and/or National Marine Fisheries Service.

aa. Historic Properties.

(1) In cases where the District Engineer determines that the activity may have the potential to cause effects to properties listed, or eligible for listing, in the National Register of Historic Places (NRHP), the activity is not authorized, until the requirements of Section 106 of the National Historic Preservation Act (NHPA) have been satisfied.

(2) Federal prospective permittees (or when FHWA is the lead federal agency) should follow their own procedures for complying with the requirements of Section 106 of the NHPA. Federal prospective permittees must provide the District Engineer with the appropriate documentation to demonstrate compliance with those requirements; this includes copies of correspondence sent to all interested, federally recognized tribes and a summary statement about tribal consultation efforts or, if the Corps enters into a Programmatic Agreement (PA) with the FHWA/NCDOT, documentation that the FHWA/NCDOT has complied with PA requirements. The District Engineer will review the documentation and determine whether it is sufficient to address Section 106 compliance for this RGP activity, or whether additional Section 106 consultation is necessary.

(3) Non-federal prospective permittees - the PCN must state which historic properties may be affected by the proposed work or include a vicinity map indicating the location of the historic properties or the potential for the presence of historic properties. Assistance regarding information on the location of or potential for the presence of historic resources can be sought from the State Historic Preservation

Officer (SHPO) and/or Tribal Historic Preservation Officer (THPO), as appropriate, and the NRHP (see 33 CFR 330.4(g)). When reviewing PCNs, the District Engineer will comply with the current procedures for addressing the requirements of Section 106 of the NHPA. The District Engineer shall make a reasonable and good faith effort to carry out appropriate identification efforts, which may include background research, consultation, oral history interviews, sample field investigation, and field survey. Based on the information submitted and these efforts, the District Engineer shall determine whether the proposed activity has the potential to cause an effect on the historic properties.

(4) Section 106 consultation is not required when the Corps determines that the activity does not have the potential to cause effects on historic properties (see 36 CFR §800.3(a)).

(5) Section 110k of the NHPA (16 U.S.C. 470h-2(k)) prevents the Corps from granting a permit or other assistance to a prospective permittee who, with intent to avoid the requirements of Section 106 of the NHPA, has intentionally significantly adversely affected a historic property to which the permit will relate, or having legal power to prevent it, allowed such significant adverse effect to occur, unless the Corps, after consultation with the Advisory Council on Historic Preservation (ACHP), determines that circumstances justify granting such assistance despite the adverse effect created or permitted by the prospective permittee. If circumstances justify granting the assistance, the Corps is required to notify the ACHP and provide documentation specifying the circumstances, the degree of damage to the integrity of any historic properties affected, and proposed mitigation. This documentation must include any views obtained from the prospective permittee, SHPO/THPO, appropriate Indian tribes if the undertaking occurs on or affects historic properties on tribal lands or affects properties of interest to those tribes, and other parties known to have a legitimate interest in the impacts to the permitted activity on historic properties.

bb. If you discover any previously unknown historic, cultural, or archeological remains and/or artifacts while accomplishing the activity authorized by this general permit, you must immediately notify the District Engineer of what you have found, and to the maximum extent practicable, avoid construction activities that may affect the remains and/or artifacts until the required coordination has been completed. The District Engineer will initiate the Federal, Tribal, and state coordination required to determine if the remains warrant a recovery effort or if the site is eligible for listing in the National Register of Historic Places.

cc. Permittees are advised that development activities in or near a floodway may be subject to the National Flood Insurance Program that prohibits any development, including fill, within a floodway that results in any increase in base flood elevations. This general permit does not authorize any activity prohibited by the National Flood Insurance Program.

dd. The permittee must install and maintain, at his/her expense, any signal lights and signals prescribed by the U.S. Coast Guard, through regulations or otherwise, on authorized facilities. For further information, the permittee should contact Coast Guard Sector North Carolina at (910) 772-2191 or email Coast Guard Fifth District at [cgd5waterways@uscg.mil](mailto:cgd5waterways@uscg.mil).

ee. The permittee must maintain any structure or work authorized by this general permit in good condition and in conformance with the terms and conditions of this general permit. The permittee is not relieved of this requirement if the permittee abandons the structure or work. Transfer in fee simple of the work authorized by this general permit will automatically transfer this general permit to the property's new owner, with all of the rights and responsibilities enumerated herein. The permittee must inform any subsequent owner of all activities undertaken under the authority of this general permit and provide the subsequent owner with a copy of the terms and conditions of this general permit.

ff. At his or her sole discretion, any time during the processing cycle, the Wilmington District Engineer may determine that this general permit will not be applicable to a specific proposal. In such case, the procedures for processing an individual permit in accordance with 33 CFR 325 will be available.

gg. Except as authorized by this general permit or any Corps approved modification to this general permit, all fill material placed in waters or wetlands shall be generated from an upland source and will be clean and free of any pollutants except in trace quantities. Metal products, organic materials (including debris from land clearing activities), or unsightly debris will not be used.

hh. Except as authorized by this general permit or any Corps approved modification to this general permit, all excavated material will be disposed of in approved upland disposal areas.

ii. Activities which have commenced (i.e., are under construction) or are under contract to commence in reliance upon this general permit will remain authorized provided the activity is completed within twelve months of the date of the general permit's expiration, modification, or revocation. Activities completed under the authorization of this general permit that were in effect at the time the activity was completed continue to be authorized by the general permit.

jj. The permittee is responsible for obtaining any "take" permits required under the USFWS's regulations governing compliance with the Migratory Bird Treaty Act or the Bald and Golden Eagle Protection Act. The permittee should contact the appropriate local office of the USFWS to determine if such "take" permits are required for a particular activity.

kk. The activity must comply with applicable FEMA approved state or local floodplain management requirements.

ll. There will be no unreasonable interference with navigation or the right of the public to riparian access by the existence or use of activities authorized by this RGP.

mm. Unless authorization to fill those specific wetlands or mudflats has been issued by the Corps, heavy equipment working in wetlands or mudflats must be placed on mats, or other measures must be taken to minimize soil disturbance.

nn. This RGP will not be applicable to proposed construction when the Wilmington District Engineer determines that the proposed activity will significantly affect the quality of the human environment and determines that an EIS must be prepared.

oo. Violation of these permit conditions or violation of Section 404 of the Clean Water Act or Section 10 of the Rivers and Harbors Act shall be reported to the Corps in writing and by telephone within 24 hours of the permittee's discovery of the violation. Corps contact information for a specific project can be found at the bottom of the RGP verification letter for that project.

BY AUTHORITY OF THE SECRETARY OF THE ARMY:

FOR THE DISTRICT COMMANDER:



KENNETH M. PORTER  
LTC, EN  
Acting Commander



NORTH CAROLINA  
Environmental Quality

JOSH STEIN  
Governor

D. REID WILSON  
Secretary

RICHARD E. ROGERS, JR.  
Director

December 19, 2025

Mr. Patrick J. Breedlove, PDEA Engineer  
NCDOT Division 14  
345 Toot Hollow Road  
Bryson City, NC 28713  
pjbreedlove@ncdot.com

Subject: 401 Water Quality Certification Pursuant to Section 401 of the Federal Clean Water Act with  
ADDITIONAL CONDITIONS for Proposed replacement of Bridge 65 on SR 1300 in Jackson County,  
TIP #B-6034. NCDWR Project No. 20251553

Dear Mr. Breedlove:

Attached hereto is a copy of Certification No. 8503 issued to The North Carolina Department of Transportation (NCDOT) dated December 19, 2025.

This approval is for the purpose and design described in your application. The plans and specifications for this project are incorporated by reference as part of this Water Quality Certification. If you change your project, you must notify the Division and you may be required to submit a new application package with the appropriate fee. If the property is sold, the new owner must be given a copy of this Certification and is responsible for complying with all conditions. [15A NCAC 02H .0507(d)(2)]. This Certification does not relieve the permittee of the responsibility to obtain all other required Federal, State, or Local approvals before proceeding with the project, including those required by, but not limited to, Sediment and Erosion Control, Non-Discharge, Water Supply Watershed, and Trout Buffer regulations.

If we can be of further assistance, do not hesitate to contact us.

Sincerely,

Signed by:

*Faith Hardin*

3185423002EA45E...

Faith Hardin, Supervisor  
401 & Buffer Transportation Permitting Branch

Attachments

cc: Crystal Amschler, USACE Asheville Regulatory Field Office (Crystal.C.Amschler@usace.army.mil)  
Dave McHenry, NC Wildlife Resources Commission (david.mchenry@ncwildlife.gov)  
File copy



North Carolina Department of Environmental Quality | Division of Water Resources  
512 North Salisbury Street | 1650 Mail Service Center | Raleigh, North Carolina 27699-1650  
919.707.9000

**401 Water Quality Certification Pursuant to Section 401 of the Federal Clean Water Act with ADDITIONAL CONDITIONS**

**THIS CERTIFICATION** is issued in conformity with the requirements of Section 401 Public Laws 92-500 and 95-217 of the United States and subject to the North Carolina Division of Water Resources (NCDWR) Regulations in 15 NCAC 2H .0500. This certification authorizes the NCDOT to impact 103 linear feet of jurisdictional streams in Jackson County. The project shall be constructed pursuant to the application dated received November 18, 2025. The authorized impacts are as described below:

**Stream Impacts in the Little Tennessee River Basin**

| Site         | Riprap Stabilization to Perennial Stream (linear ft) | Temporary Dewatering to Perennial Stream (linear ft) | Total Stream Impact (linear ft) |
|--------------|--|--|---------------------------------|
| <b>Total</b> | <b>53</b>  | <b>50</b>  | <b>103</b>                      |

**Total Stream Impact for Project: 103 linear feet**

The application provides adequate assurance that the discharge of fill material into the waters of the Little Tennessee River Basin in conjunction with the proposed development will not result in a violation of applicable Water Quality Standards and discharge guidelines. Therefore, the State of North Carolina certifies that this activity will not violate the applicable portions of Sections 301, 302, 303, 306, 307 of PL 92-500 and PL 95-217 if conducted in accordance with the application and conditions hereinafter set forth.

This approval is only valid for the purpose and design that you submitted in your application dated received November 18, 2025. Should your project change, you are required to notify the NCDWR and submit a new application. If the property is sold, the new owner must be given a copy of this Certification and approval letter, and is thereby responsible for complying with all the conditions. If any additional wetland impacts, or stream impacts, for this project (now or in the future) exceed 0.1 acre or 300 linear feet, respectively, additional compensatory mitigation may be required as described in 15A NCAC 2H .0506 (h) (6) and (7).

For this approval to remain valid, you are required to comply with all the conditions listed below. In addition, you should obtain all other federal, state or local permits before proceeding with your project including (but not limited to) Sediment and Erosion control, Coastal Stormwater, Non-discharge and Water Supply watershed regulations. This Certification shall expire on the same day as the expiration date of the corresponding Corps of Engineers Permit.

This Water Quality Certification neither grants nor affirms any property right, license, or privilege in any lands or waters, or any right of use in any waters. This Water Quality Certification does not authorize any person to interfere with the riparian rights, littoral rights, or water use rights of any other person and does not create any prescriptive right or any right of priority regarding any usage of water. This Water Quality Certification shall not be interposed as a defense in any action respecting the determination of riparian or littoral rights or other rights to water use. No consumptive user is deemed by virtue of this Water Quality Certification to possess any prescriptive or other right of priority with respect to any other consumptive user regardless of the quantity of the withdrawal or the date on which the withdrawal was initiated or expanded. Upon the presentation of proper credentials, the Division may inspect the property.

**Conditions of Certification:**

1. As a condition of this 401 Water Quality Certification, the bridge demolition and construction must be accomplished in strict compliance with the most recent version of NCDOT’s Best Management Practices for Construction and Maintenance Activities. [15A NCAC 02H .0507(d)(2) and 15A NCAC 02H .0506(b)(5)]



2. The post-construction removal of any temporary bridge structures must return the project site to its preconstruction contours and elevations. The impacted areas shall be revegetated with appropriate native species. [15A NCAC 02H .0506(b)(2)]
3. Bridge deck drains shall not discharge directly into the stream. Stormwater shall be directed across the bridge and pre-treated through site-appropriate means (grassed swales, pre-formed scour holes, vegetated buffers, etc.) before entering the stream. To meet the requirements of NCDOT's NPDES permit NCS0000250, please refer to the most recent version of the *North Carolina Department of Transportation Stormwater Best Management Practices Toolbox* manual for approved measures. [15A NCAC 02H .0507(d)(2) and 15A NCAC 02H .0506(b)(5)]
4. No drill slurry or water that has been in contact with uncured concrete shall be allowed to enter surface waters. This water shall be captured, treated, and disposed of properly. [15A NCAC 02H .0506(b)(3)]
5. A turbidity curtain will be installed in the stream if driving or drilling activities occur within the stream channel, on the stream bank, or within 5 feet of the top of bank, or during the removal of bents from an old bridge. This condition can be waived with prior approval from the NCDWR. [15A NCAC 02H .0506(b)(3)]
6. For projects impacting waters classified by the NC Environmental Management Commission as Trout (Tr), stormwater shall be directed to vegetated buffer areas, grass-lined ditches or other means appropriate to the site for the purpose of pre-treating storm water runoff prior to discharging directly into streams. Mowing of existing vegetated buffers is strongly discouraged. [15A NCAC 2B.0224]
7. The permittee shall use *Design Standards in Sensitive Watersheds* (15A NCAC 4B.0124) in areas draining Trout waters.
8. The permittee will need to adhere to all appropriate in-water work moratoria (including the use of pile driving or vibration techniques) prescribed by the NC Wildlife Resources Commission. No in-water work is permitted between October 15 and April 15 of any year, without prior approval from the NC Division of Water Resources and the NC Wildlife Resources Commission.
9. NCDOT shall be in compliance with the NCS00250 issued to the NCDOT, including the applicable requirements of the NCG01000. Please note the extra protections for the sensitive watersheds. If sediment or other pollutants are found to be discharged from the stormwater outfalls, DWR may take enforcement action.
10. If concrete is used during construction, a dry work area shall be maintained to prevent direct contact between curing concrete and stream water. Water that inadvertently contacts uncured concrete shall not be discharged to surface waters due to the potential for elevated pH and possible aquatic life and fish kills. [15A NCAC 02B.0200]
11. For all streams being impacted due to site dewatering activities, the site shall be graded to its preconstruction contours and revegetated with appropriate native species. [15A NCAC 02H.0506(b)(2)]
12. During the construction of the project, no staging of equipment of any kind is permitted in waters of the U.S., or protected riparian buffers. [15A NCAC 02H.0506(b)(2)]
13. The dimension, pattern and profile of the stream above and below the crossing shall not be modified. Disturbed floodplains and streams shall be restored to natural geomorphic conditions. [15A NCAC 02H.0506(b)(2)]
14. Any rip-rap placed for stream stabilization shall be placed in stream channels in such a manner that it does not impede aquatic life passage. [15A NCAC 02H.0506(b)(2)]
15. The Permittee shall ensure that the final design drawings adhere to the permit and to the permit drawings submitted for approval. [15A NCAC 02H .0507 (c) and 15A NCAC 02H .0506 (b)(2) and (c)(2)]
16. All work in or adjacent to stream waters shall be conducted in a dry work area. Approved BMP measures from the most current version of NCDOT Construction and Maintenance Activities manual such as sandbags, rock berms, cofferdams and other diversion structures shall be used to prevent excavation in flowing water. [15A NCAC 02H.0506(b)(3) and (c)(3)]



17. Heavy equipment shall be operated from the banks rather than in the stream channel in order to minimize sedimentation and reduce the introduction of other pollutants into the stream. [15A NCAC 02H.0506(b)(3)]
18. All mechanized equipment operated near surface waters must be regularly inspected and maintained to prevent contamination of stream waters from fuels, lubricants, hydraulic fluids, or other toxic materials. [15A NCAC 02H.0506(b)(3)]
19. No rock, sand or other materials shall be dredged from the stream channel except where authorized by this certification. [15A NCAC 02H.0506(b)(3)]
20. Discharging hydroseed mixtures and washing out hydroseeders and other equipment in or adjacent to surface waters is prohibited. [15A NCAC 02H.0506(b)(3)]
21. The permittee and its authorized agents shall conduct its activities in a manner consistent with State water quality standards (including any requirements resulting from compliance with §303(d) of the Clean Water Act) and any other appropriate requirements of State and Federal law. If the NCDWR determines that such standards or laws are not being met (including the failure to sustain a designated or achieved use) or that State or federal law is being violated, or that further conditions are necessary to assure compliance, the NCDWR may reevaluate and modify this certification. [15A NCAC 02B.0200]
22. A copy of this Water Quality Certification shall be maintained on the construction site at all times. In addition, the Water Quality Certification and all subsequent modifications, if any, shall be maintained with the Division Engineer and the on-site project manager. [15A NCAC 02H .0507(c) and 15A NCAC 02H .0506 (b)(2) and (c)(2)]
23. The outside buffer, wetland or water boundary located within the construction corridor approved by this authorization, including all non-commercial borrow and waste sites associated with the project, shall be clearly marked by highly visible fencing prior to any land disturbing activities. Impacts to areas within the fencing are prohibited unless otherwise authorized by this certification. [15A NCAC 02H.0501 and .0502]
24. The issuance of this certification does not exempt the Permittee from complying with any and all statutes, rules, regulations, or ordinances that may be imposed by other government agencies (i.e. local, state, and federal) having jurisdiction, including but not limited to applicable buffer rules, stormwater management rules, soil erosion and sedimentation control requirements, etc.
25. The Permittee shall report any violations of this certification to the Division of Water Resources within 24 hours of discovery. [15A NCAC 02B.0506(b)(2)]
26. Upon completion of the project (including any impacts at associated borrow or waste sites), the NCDOT Division Engineer shall complete and return the "Certification of Completion Form" to notify the NCDWR when all work included in the 401 Certification has been completed. [15A NCAC 02H.0507]
27. Native riparian vegetation (i.e., herbaceous, trees, and shrubs native to your geographic region) must be reestablished in the riparian areas within the construction limits of the project by the end of the growing season following completion of construction. [15A NCAC 02B.0506(b)(2)]
28. There shall be no excavation from, or waste disposal into, jurisdictional wetlands or waters associated with this permit without appropriate modification. Should waste or borrow sites, or access roads to waste or borrow sites, be located in wetlands or streams, compensatory mitigation will be required since that is a direct impact from road construction activities. [15A NCAC 02H.0506(b)(3) and (c)(3)]
29. Erosion control matting that incorporates plastic mesh and/or plastic twine shall not be used along streambanks or within riparian areas. Coir matting should be used on disturbed banks and anchored with wooden stakes according to DOT specifications. [15A NCAC 2H.0506; 15A NCAC 2H.0507]



30. Erosion and sediment control practices must be in full compliance with all specifications governing the proper design, installation and operation and maintenance of such Best Management Practices in order to protect surface waters standards [15A NCAC 02H.0506(b)(3) and (c)(3)]:

- a. The erosion and sediment control measures for the project must be designed, installed, operated, and maintained in accordance with the most recent version of the *North Carolina Sediment and Erosion Control Planning and Design Manual*.
- b. The design, installation, operation, and maintenance of the sediment and erosion control measures must be such that they equal, or exceed, the requirements specified in the most recent version of the *North Carolina Sediment and Erosion Control Manual*. The devices shall be maintained on all construction sites, borrow sites, and waste pile (spoil) projects, including contractor-owned or leased borrow pits associated with the project.
- c. For borrow pit sites, the erosion and sediment control measures must be designed, installed, operated, and maintained in accordance with the most recent version of the *North Carolina Surface Mining Manual*.
- d. The reclamation measures and implementation must comply with the reclamation in accordance with the requirements of the Sedimentation Pollution Control Act.

31. Sediment and erosion control measures shall not be placed in wetlands or surface waters, or within 5 feet of the top of bank, without prior approval from DWR. [15A NCAC 02H.0506(b)(3) and (c)(3)]

32. When applicable, all construction activities shall be performed and maintained in full compliance with G.S. Chapter 113A Article 4 (Sediment and Pollution Control Act of 1973). Regardless of applicability of the Sediment and Pollution Control Act, all projects shall incorporate appropriate Best Management Practices for the control of sediment and erosion so that no violations of state water quality standards, statutes, or rules occur. [15A NCAC 02H .0506 {b)(3) and (c)(3) and 15A NCAC 02B .0200]

33. Design, installation, operation, and maintenance of all sediment and erosion control measures shall be equal to or exceed the requirements specified in the most recent version of the *North Carolina Sediment and Erosion Control Manual*, or for linear transportation projects, the *NCDOT Sediment and Erosion Control Manual*.

All devices shall be maintained on all construction sites, borrow sites, and waste pile (spoil) sites, including contractor-owned or leased borrow pits associated with the project. Sufficient materials required for stabilization and/or repair of erosion control measures and stormwater routing and treatment shall be on site at all times. For borrow pit sites, the erosion and sediment control measures shall be designed, installed, operated, and maintained in accordance with the most recent version of the *North Carolina Surface Mining Manual*. Reclamation measures and implementation shall comply with the reclamation in accordance with the requirements of the Sedimentation Pollution Control Act and the Mining Act of 1971.

If the project occurs in waters or watersheds classified as Trout (Tr), then the sedimentation and erosion control designs shall comply with the requirements set forth in 15A NCAC 04B .0124, *Design Standards in Sensitive Watersheds*. [15A NCAC 02H.0506(b)(3) and (c)(3)]

This Certification shall become null and void unless the above conditions are made conditions of the Federal 404 and/or Coastal Area Management Act Permit. This Certification shall expire upon the expiration of the 404 or CAMA permit. Please be aware that impacting waters without first applying for and securing the issuance of a 401 Water Quality Certification violates Title 15A of the North Carolina Administrative Code (NCAC) 2H .0500. Title 15A NCAC 2H .0500 requires certifications pursuant to Section 401 of the Clean Water Act whenever construction or operation of facilities will result in a discharge into navigable waters, including wetlands, as described in 33 Code of Federal Regulations (CFR) Part 323. It also states any person desiring issuance of the State certification or coverage under a general certification required by Section 401 of the Federal Water Pollution Control Act shall file with the Director of the North Carolina Division of Water Quality. Violations of any condition herein set forth may result in revocation of this Certification and may result in criminal and/or civil penalties. Pursuant to G.S. 143-215.6A, these violations and any future violations are subject to a civil penalty assessment of up to a maximum of \$25,000.00 per day for each violation.



This approval and its conditions are final and binding unless contested [G.S. 143-215.5]. Please be aware that impacting waters without first applying for and securing the issuance of a 401 Water Quality Certification violates Title 15A of the North Carolina Administrative Code (NCAC) 2H .0500. Title 15A NCAC 2H .0500 requires certifications pursuant to Section 401 of the Clean Water Act whenever construction or operation of facilities will result in a discharge into navigable waters, including wetlands, as described in 33 Code of Federal Regulations (CFR) Part 323. It also states any person desiring issuance of the State certification or coverage under a general certification required by Section 401 of the Federal Water Pollution Control Act shall file with the Director of the North Carolina Division of Water Quality. Pursuant to G.S. 143-215.6A, these violations and any future violations are subject to a civil penalty assessment of up to a maximum of \$25,000.00 per day for each violation.

This Certification can be contested as provided in Chapter 150B of the North Carolina General Statutes by filing a Petition for a Contested Case Hearing (Petition) with the North Carolina Office of Administrative Hearings (OAH) **within sixty (60) calendar days**. Requirements for filing a Petition are set forth in Chapter 150B of the North Carolina General Statutes and Title 26 of the North Carolina Administrative Code. Additional information regarding requirements for filing a Petition and Petition forms may be accessed at <http://www.ncoah.com/> or by calling the OAH Clerk's Office at (919) 431-3000.

A party filing a Petition must serve a copy of the Petition on:  
Dan Hirschman, General Counsel  
Department of Environmental Quality  
1601 Mail Service Center  
Raleigh, NC 27699-1601

If the party filing the Petition is not the permittee, then the party must also serve the recipient of the Certification in accordance with N.C.G.S 150B-23(a).

This the 19th day of December 2025

DIVISION OF WATER RESOURCES

Signed by:

*Faith Hardin*

3185423002EA45E...

Faith Hardin, Supervisor  
401 & Buffer Transportation Permitting Branch

WQC No. 8503

